

## DETAILS

Product Number	C11552_BARBARA-S
Family	Barbara
Type	Reflector
Color	metal
Diameter	70 mm
Height	44,7 mm
Style	round
Optic Material	PC
Holder Material	
Fastening	glue
Status	production ready
ROHS Compliant	Yes
Date Updated	17/05/2016



## OPTICAL PROPERTIES

LED	Viewing Angle	Light Beam	Effi- ciency	cd/lm	Connector
CLU730	sim: 14	Spot	sim: 91 %	sim: 6.140	-
NSBxL110	16 deg	Spot	90 %	sim: 2.800	-
BXRA ES Rectangle	17 deg	Spot	90 %	5.060	-
CL-L330	17 deg	Spot	90 %	5.000	-
CXA2011	17 deg	Spot	90 %	4.540	-
COB 10W/13W/17W/24W	19 deg	Spot	90 %	4.100	-

**Relative intensity of C11552\_BARBARA-S (COB-10W)**

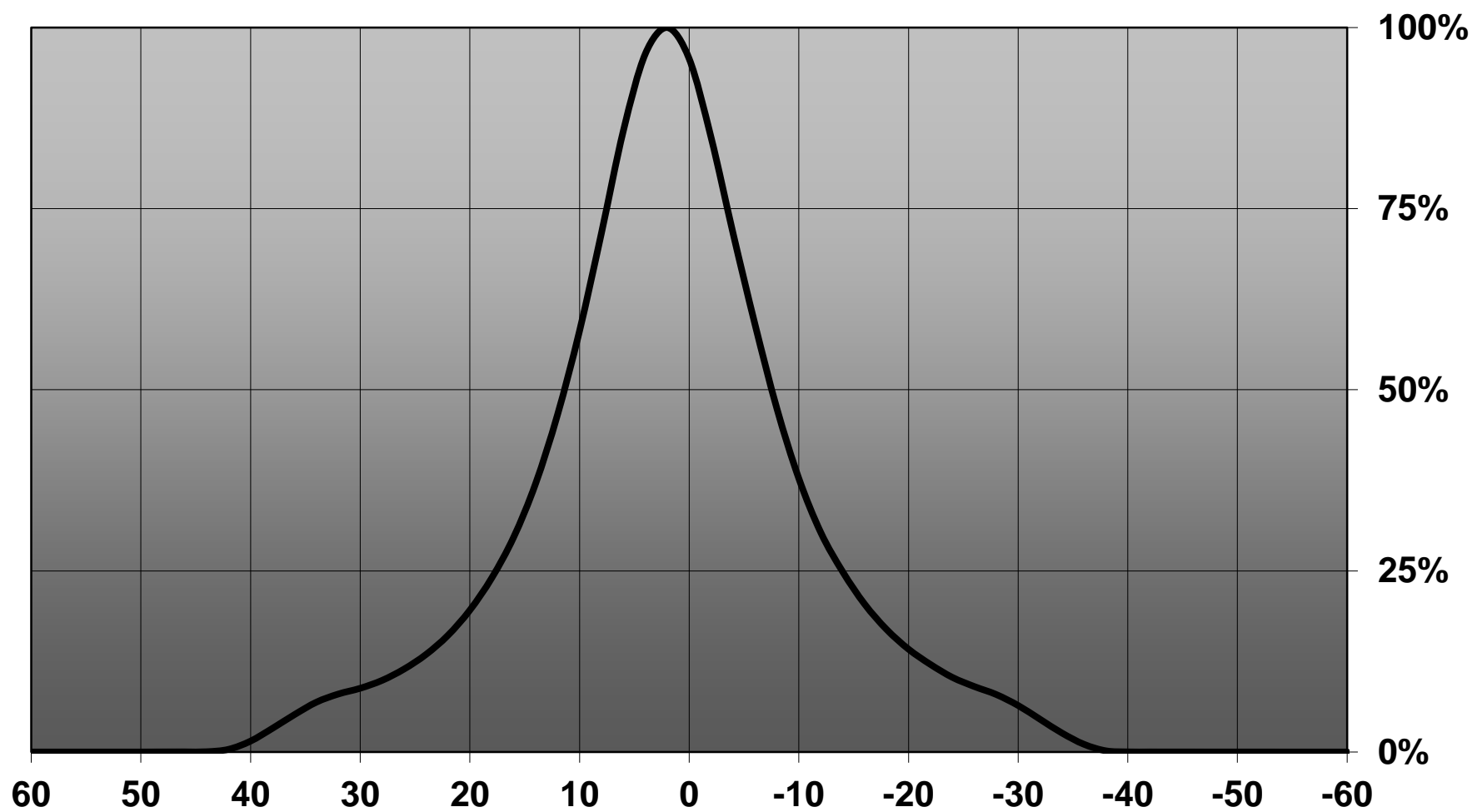

D

C

B

A

4

4

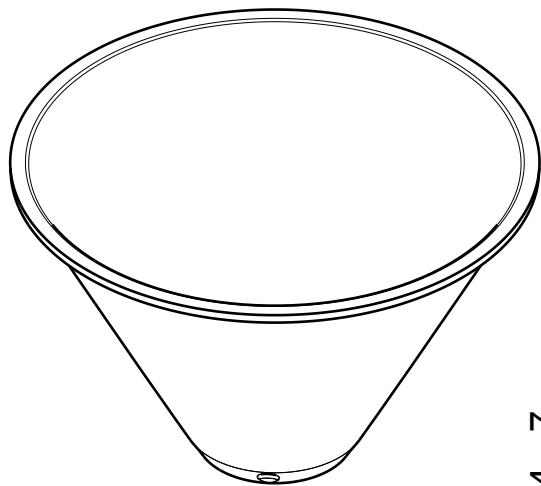

Isometric view

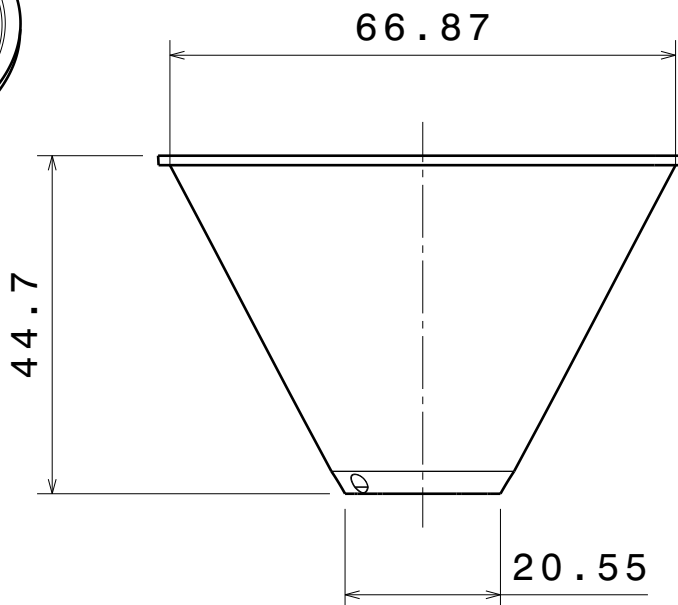

Front view

3

3

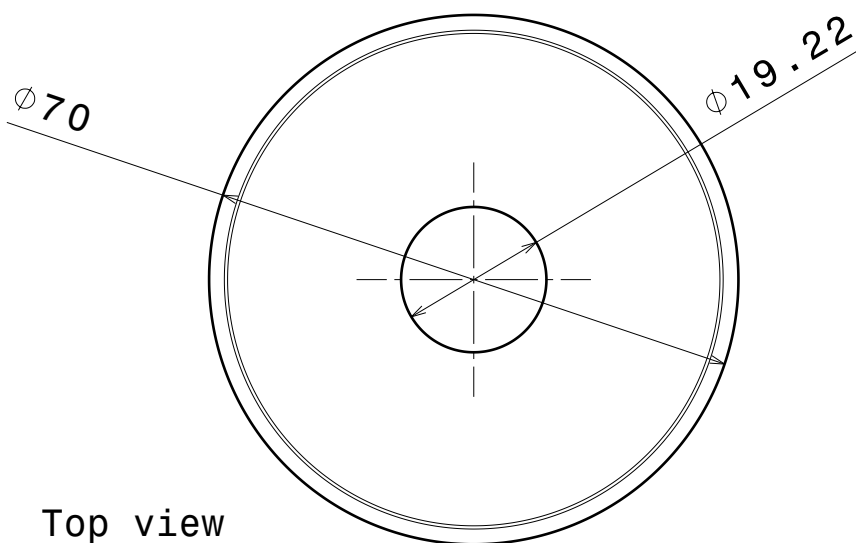

Top view

2

2

INDEX	DESCRIPTION	MATERIAL	COLOUR
1	Barbara reflector	PC	metal

Tolerances if not otherwise shown  
According to DIN ISO 2768-1  
Linear measures:  
up to 30mm class M, otherwise class C  
According to DIN ISO 2768-2  
Form and position: class L

**LEDiL**

Ledil Oy  
Salorankatu 10  
FIN 24240 SALO  
Finland

THIRD ANGLE PROJECTION:

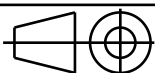

DRAWING TITLE

Barbara series datasheet

This drawing is the property  
of LEDiL Oy. It may not be  
reproduced, copied or  
communicated without a written  
agreement with LEDiL Oy.

SIZE

A4

PART NUMBER

-

SCALE

1:1

WEIGHT

-

SHEET

1/1

1

1

D

A

Luminaire: Ledil Oy C11552\_BARBARA-S\_(NSBxL110)\_SIMULATED  
Lamps: 1 x Nichia NSBxL110 (NSBLL110)

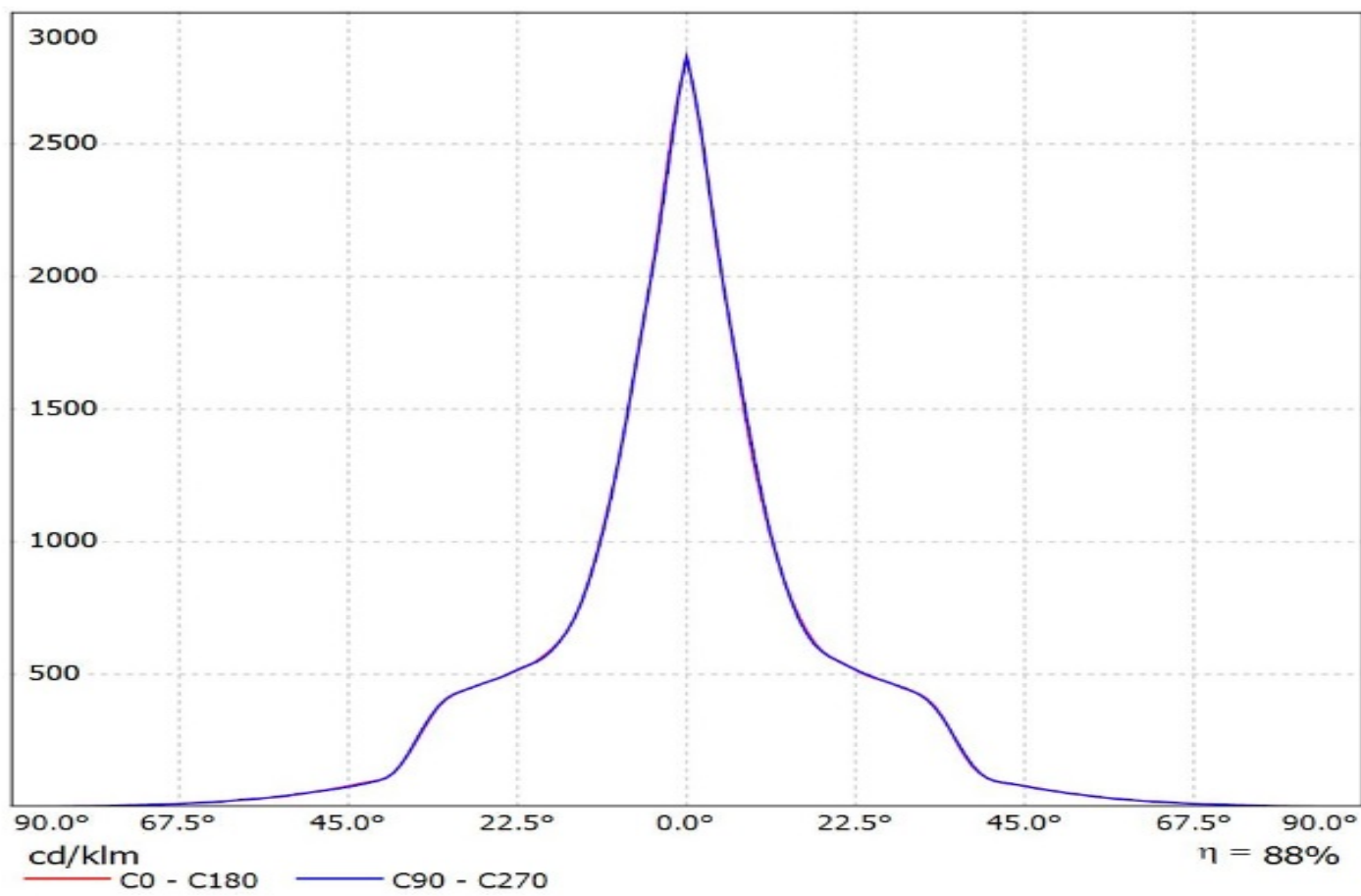

Luminaire: Ledil Oy C11552\_Barbara-S C11552\_Barbara-S  
Lamps: 1 x Bridgelux BXRA-C2002 (Wh

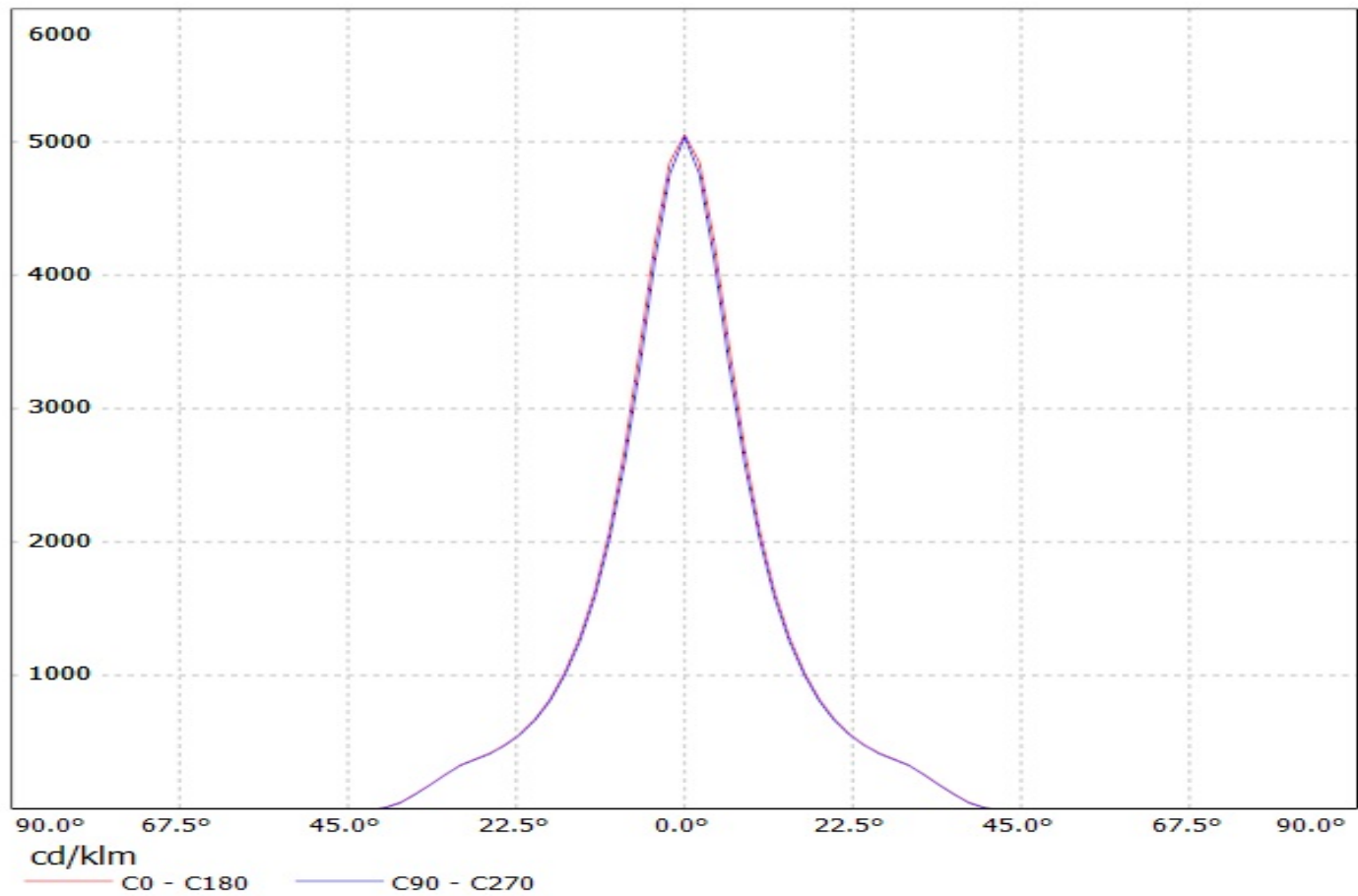

# Ledil Oy C11552\_Barbara-S\_CL-L330 C11552\_Barbara-S\_CL-L330 / LDC (Linear)

Luminaire: Ledil Oy C11552\_Barbara-S\_CL-L330 C11552\_Barbara-S\_CL-L330  
Lamps: 1 x Citizen CL-L330 white

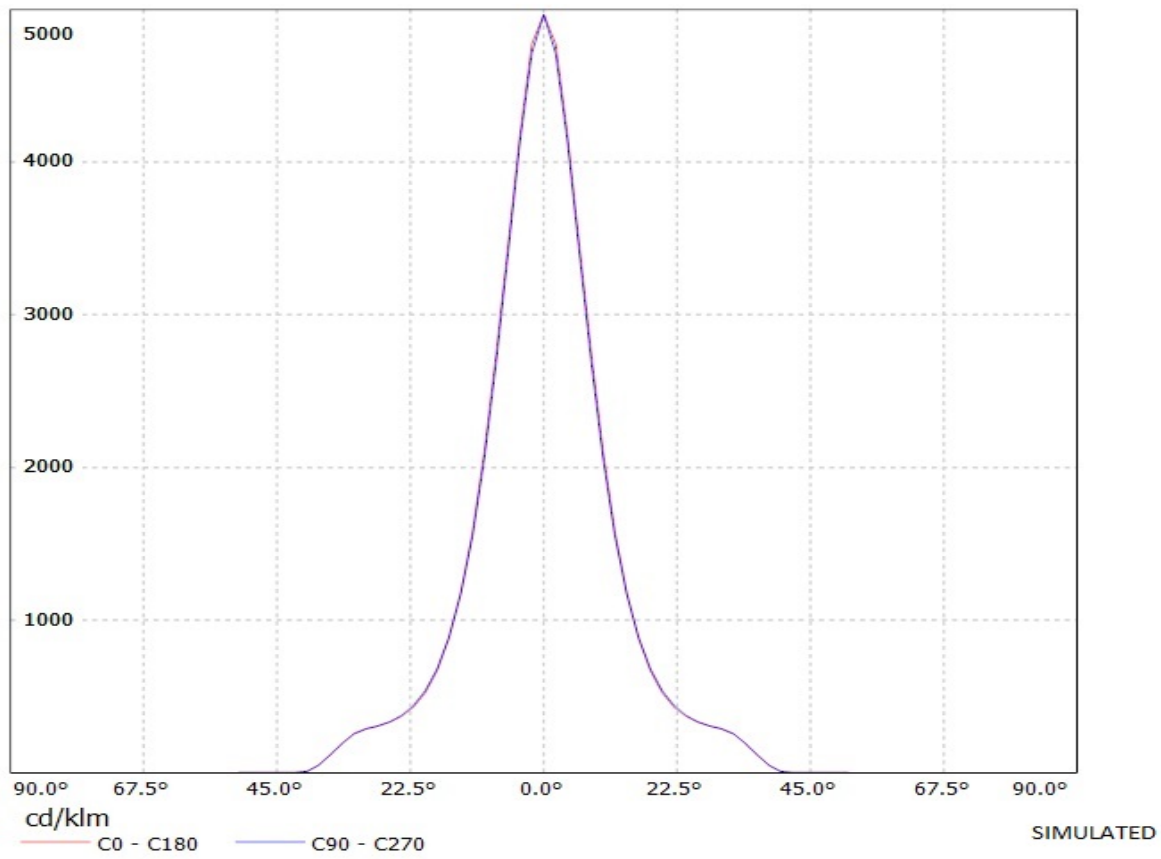

Luminaire: Ledil Oy C11552\_BARBARA-S\_(NSBxL110)\_SIMULATED  
Lamps: 1 x Nichia NSBxL110 (NSBLL110)

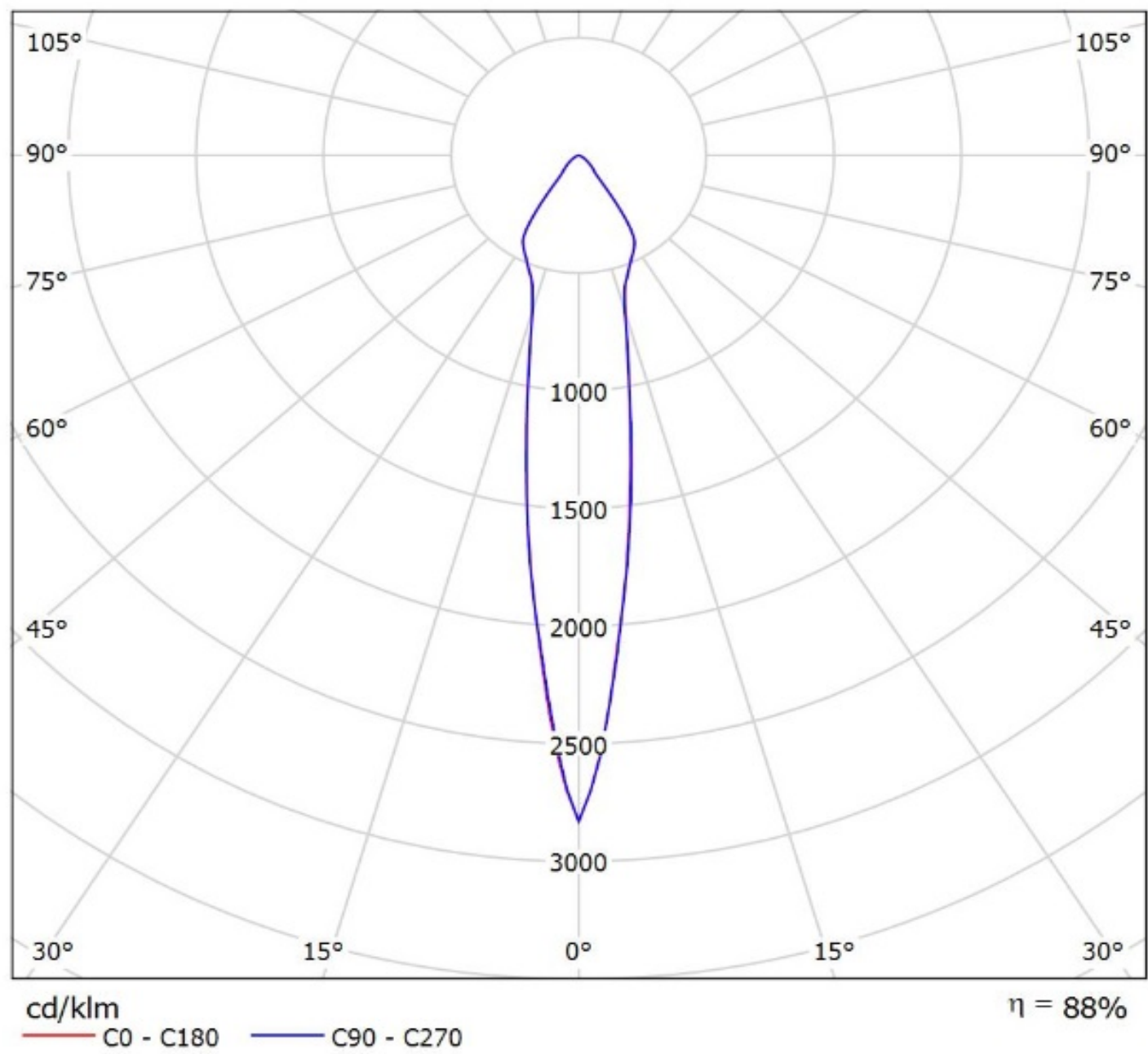

Luminaire: Ledil Oy C11552\_Barbara-S C11552\_Barbara-S  
Lamps: 1 x Bridgelux BXRA-C2002 (Wh

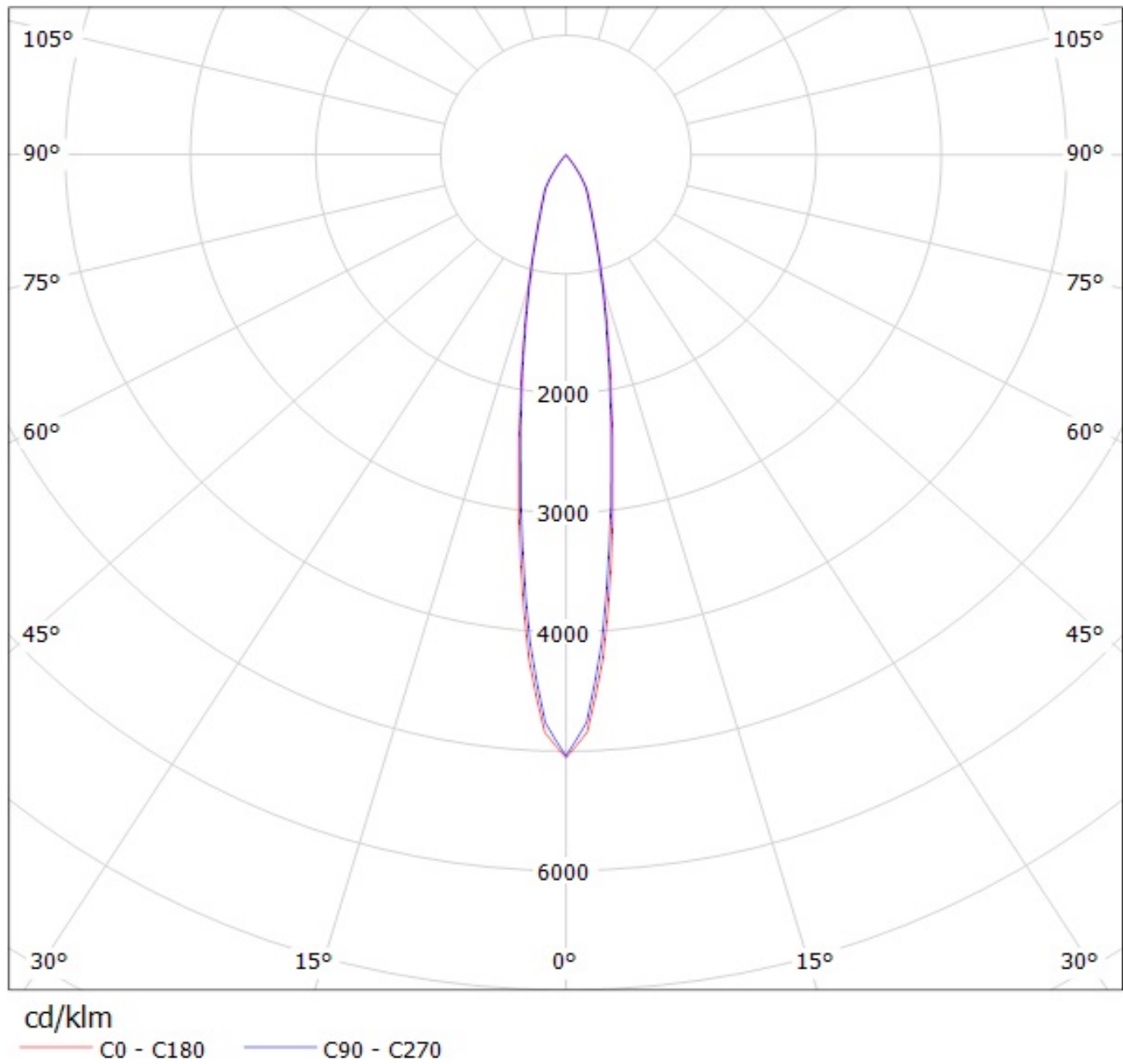



## Ledil Oy C11552\_Barbara-S\_CL-L330 C11552\_Barbara-S\_CL-L330 / LDC (Polar)

Luminaire: Ledil Oy C11552\_Barbara-S\_CL-L330 C11552\_Barbara-S\_CL-L330

Lamps: 1 x Citizen CL-L330 white

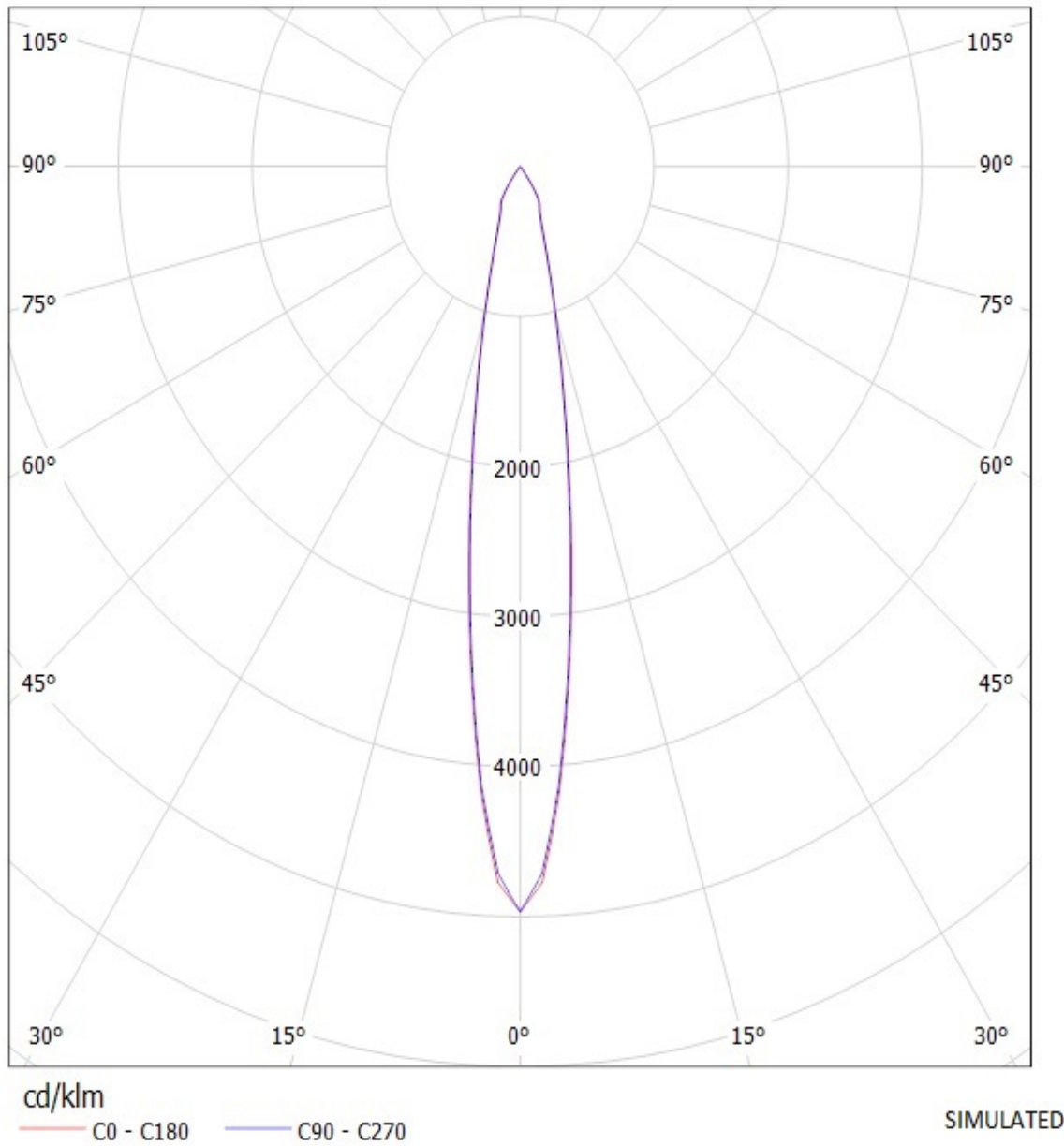

**NOTE: The typical divergence will be changed by different color, chip size and chip position tolerance. The typical total divergence is the full angle measured where the luminous intensity is half of the peak value.**

## **GENERAL INFORMATION**

- Product series especially designed & optimized for series of LEDs.
- Special care taken to make light distribution as uniform as possible.
- Fastening to PCB with appropriate adhesive. By clicking link below you can find Ledil recommended glue options.  
[http://www.ledil.com/datasheets/DataSheet\\_GLUES.pdf](http://www.ledil.com/datasheets/DataSheet_GLUES.pdf)

Note! Due to use of high power COB's with this product, special attention to proper thermal design is highly recommended. LEDiL has no liability for direct, indirect or consecutive damages arising from the LEDiL products being used outside of the recommended temperature range.

**NOTE 1: We advise customer to ensure the suitability and sufficiency of the bond in the end product. For example, mechanical stress, vibration and holes on the surface of the circuit board weaken the strength of the glue.**

**NOTE 2: All surfaces where glue is applied must be clean, dry and free from grease and dirt. If cleaning of PCB surfaces is needed, please follow strictly the cleaning instructions of your LED manufacturer -this is important as cleaning shall under no circumstances damage LEDs or other electronics components on the PCB.**

**Further note that optical components shall not be cleaned with any chemicals - only micro fiber cloth may be used to remove fingerprints or other traces from handling.**