

Pin	Symbol	Value
1	VDD	179.9±0.1(COVER O/D)
2	VDD	167.75(SENSOR O/D)
3	VDD	165.75±0.3(TFT O/D)
4	NC	156.2±0.2(OPEN)
5	RESIST	154.6±0.1(COVER V/A)
6	STRIP	153.6(LCD A.A)
7	GND	90
8	DATA+	(4.96)
9	DATA-	5.93±0.3
10	GND	0.125(HARD COATING PROTECT FILM)
11	DATA+	1.1±0.1(COVER GLASS)
12	DATA+	0.55±0.1(TO SENSOR)
13	GND	0.15(BOTTOM GLUE)
14	DATA-	3.2±0.5
15	DATA-	
16	GND	
17	EXCLUSE-	
18	RECTIFY-	
19	GND	
20	DATA-	
21	DATA-	
22	GND	
23	NC	
24	NC	
25	GND	
26	NC	
27	DRAW	
28	STRIP	
29	AND	
30	GND	
31	LED+	
32	LED+	
33	LED+	
34	LED+	
35	VEL	
36	CORNER	
37	CORNER	
38	VEL	
39	LED-	
40	LED-	

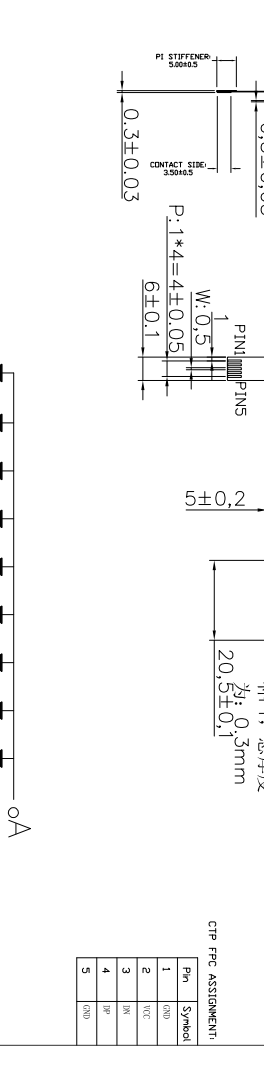
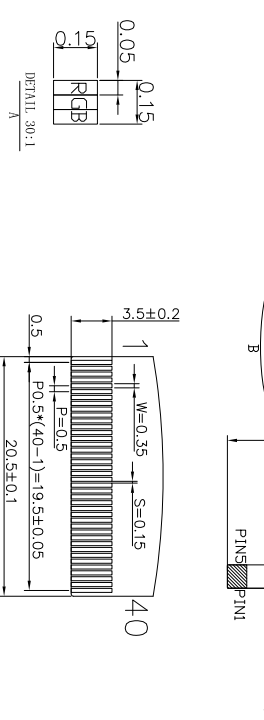
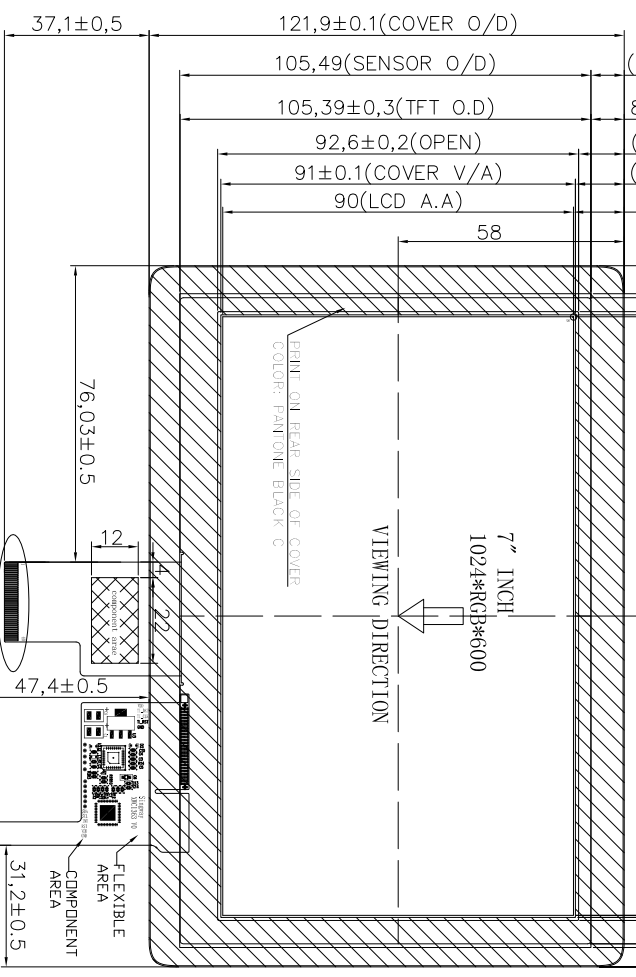

NOTES FOR TFT:

1. DISPLAY TYPE: TFT, TRANSMISSIVE, NORMALLY WHITE.
2. LOGIC VOLTAGE: VDD=3.3V.
3. VIEWING DIRECTION: 12 O'CLOCK.
4. IC DRIVER: NT51008CH-D+NT52002H-D
5. OPERATING TEMP: -20°C ~ 70°C.
6. STORAGE TEMP: -30°C ~ 80°C.
7. LED BACKLIGHT: 27-LED WHITE, If=180mA, Vf=9.6V.
8. SURFACE LUMINANCE: 420cd/m²(TYP).
9. TOP POLARIZER SURFACE TREATMENT: GLARE.
10. GENERAL TOLERANCE: ±0.2.
11. RoHS COMPLIANT.

NOTES FOR CTP:

1. 7.0 INCH PROJECTIVE CAPACITIVE TOUCH PANEL.
2. OPERATING VOLTAGE: VCC=5.0V.
3. COVER GLASS + SENSOR GLASS + FPCA.
4. RESOLUTION: 4096 X 4096 DOTS.
5. IC DRIVER: GT9111+NUC122+AMS1117.
6. MULTI FINGER: UP TO 5.
7. HARDNESS OF COVER SURFACE: 6H.

CIRCUIT DIAGRAM

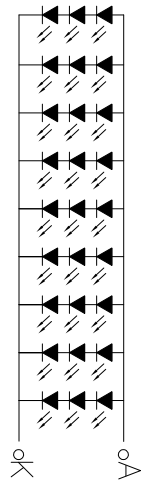

CTP PFC ASSIGNMENT:

Pin	Symbol
1	GND
2	VCC
3	IN
4	DP
5	GND

MUTLI-INNO TECHNOLOGY CO., LTD.

DRAWN BY: RITA	2016.06.14	SCALE: 1/1	MODULE P/N: M0700XT-19CP
CHECKED BY:		UNIT: mm	DESCRIPTION: TFT MODULE
APPROVED BY:			
VERSION NO.: 01			

01	First Issue	2016.06.14	DATE
VER.	REVISED DESCRIPTION		