

# VECO VANSONIC ENTERPRISE CO., LTD.

8F., No. 7, Lane 16, Sec. 2, Szechwan Road, Panchiao, Taipei Hsien, TAIWAN.

TEL: +886-2-29626335

TEL: +886-2-29625220

E-MAIL: vansonice@ms4.hinet.net

1.	<b>MODEL:</b>	<b>20CS08FS</b> -M38ND(Black Mylar)-M38NT(Clear Mylar)		
2.	Dimension	Outer Diameter	<b>20</b>	mm. Baffle Opening
		Height	<b>Refer to Drawing</b>	Weight
3.	Magnet	Materials	<b>Rare Earth</b>	Size $\phi$ <b>6.5x1.0</b> mm.
4.	Nominal Impedance	<b>8</b>	$\pm$ <b>15</b> %	At <b>1500</b> Hz.
5.	Power Rating	Normal	<b>500</b> mW.	Maximum <b>1000</b> mW.
6.	Lowest Resonant Frequency	<b>900</b>	$\pm$ <b>20</b> %	Hz.
7.	Output Sound Pressure Level (S.P.L.)	<b>77</b>	$\pm$ <b>3</b> db / 0.5 Watt	0.5 Meter.
		Average at	<b>800, 1000, 1200, 1500</b>	Hz.
8.	Frequency Range	<b>500</b>	~ <b>7000</b> Hz.	Average S P L - 10 db.
9.	Distortion	<b>5</b> %	Maximum At	<b>1000</b> Hz. <b>500</b> mW.
10.	Abnormal Sound Test	Must Be Normal Test By <b>2.0</b> Volts. Sine Wave.		
11.	Load Test	White Noise With Weighted Filter <b>2.0</b> Volts.(RMS) <b>24</b> Hrs.		
12.	Polarity	Diaphragm shall move Forward when Apply a Positive DC.		
		Current to the "+" or "Marked" Terminal.		

## MOUNTING NOTICE

At Least  
0.5mm  
For  
Diaphragm  
Moving

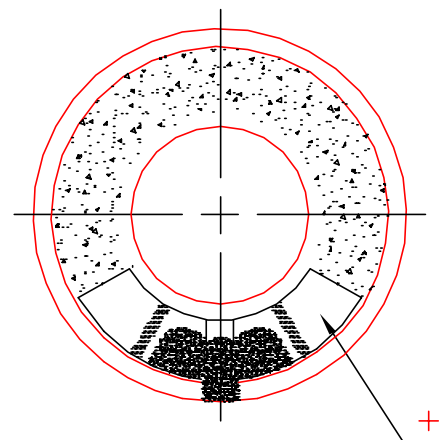
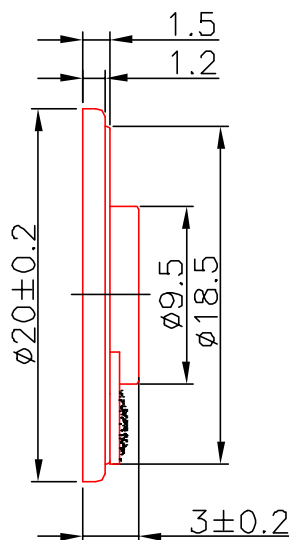
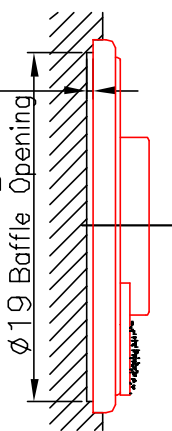

Unit : mm

Housing Material : METAL

20CS08FS-M38ND VOL:2.0U(0.5W) DIS:0.5M VANSOONIC  
X:1.0000kHz \*Y:78.89dB ZA:Live Curve SSR Fund.

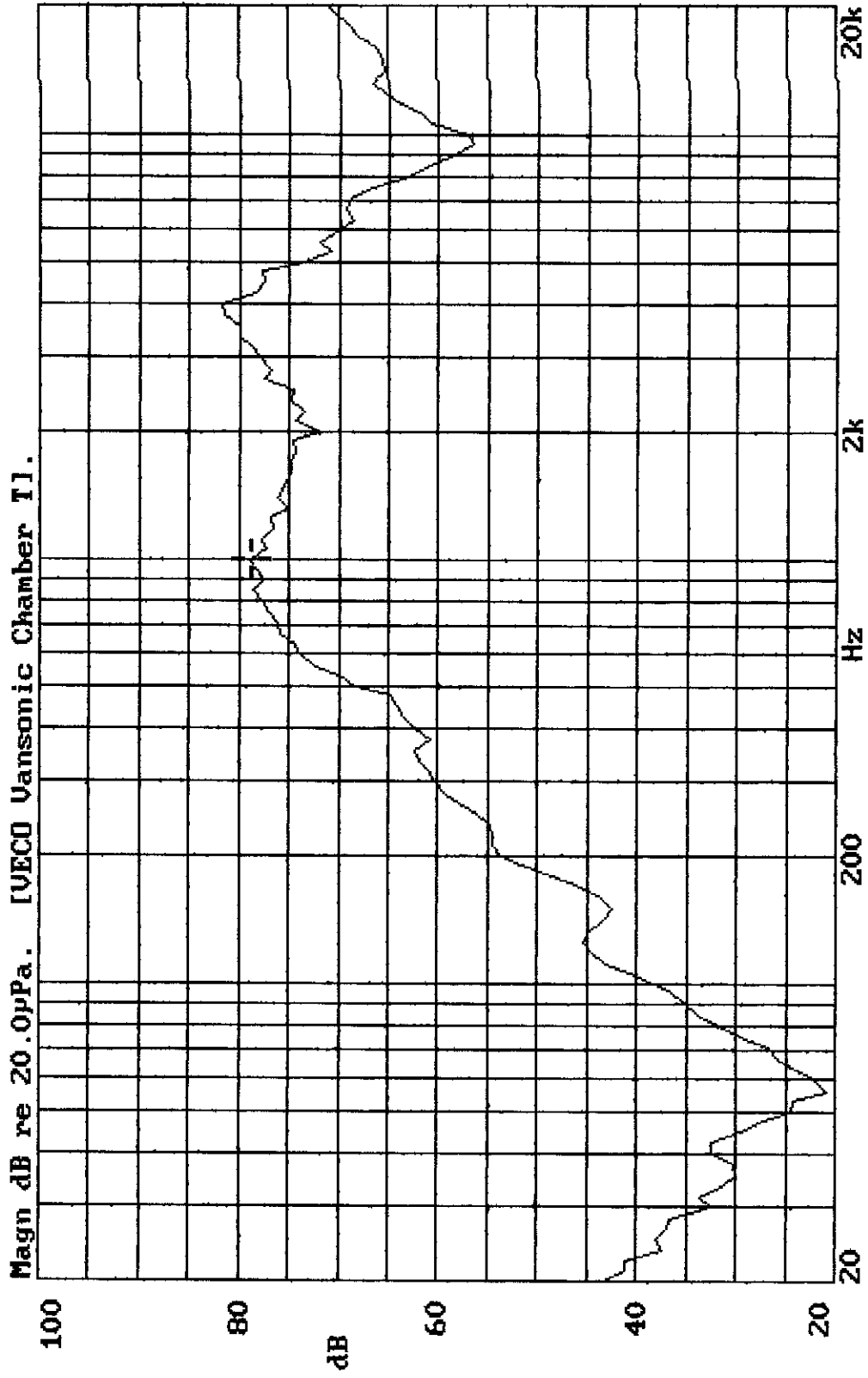

10-FEB-2000 10:27:01

Mode: SSR

