

VECO VANSONIC ENTERPRISE CO.,LTD.

8F., No7, Lane16, Sec2, Szechwan Road, Panchiao, Taipei Hsien, TAIWAN.
 E-mail: Vansonic@ms4.hinet.net Homepage: <http://www.veco.com.tw>
 TEL: +886-2-962 6335 FAX: +886-2-962 5220

1.	MODEL:	20VS08PL DYNAMIC SPEAKER
2.	Dimension	Outer Diameter 19.5x13.5 mm.
		Height Refer to Fig 1 mm. Weight 2.2 Grams.
3.	Magnet	Materials NdFeB
4.	Impedance	8 W ± 15 % At 1000 Hz.
5.	Power Rating	Normal 1.0 W. Maximum 1.5 W.
6.	Lowest Resonant Frequency	900 ± 20% Hz at 1.0V measured by SUNLILAB® 7117C
7.	Output Sound Pressure (S.P.L.)	80 ± 3 db / 1.0Watt · 0.5Meter , Measured by B&K Type 2012
		At 800, 1000, 1200, 1500, HZ Average
8.	Frequency Range	500 ~ 20,000+ Hz. Average SPL -10db Refer to Fig. 2
9.	Distortion	5 % Maximum at 1500 Hz 1.0 W.
10.	Abnormal Sound Test	Must be Normal Tested By 2.83 Volts. Sine Wave.
11.	Load Test	Pink noise with HPF(High Pass Filter 235HZ-3db-11db/Oct) 2.83 Volts(RMS.) 24 hrs.
12.	Storage Temperature	- 25 ~ +70
13.	Operating Temperature	- 20 ~ +60

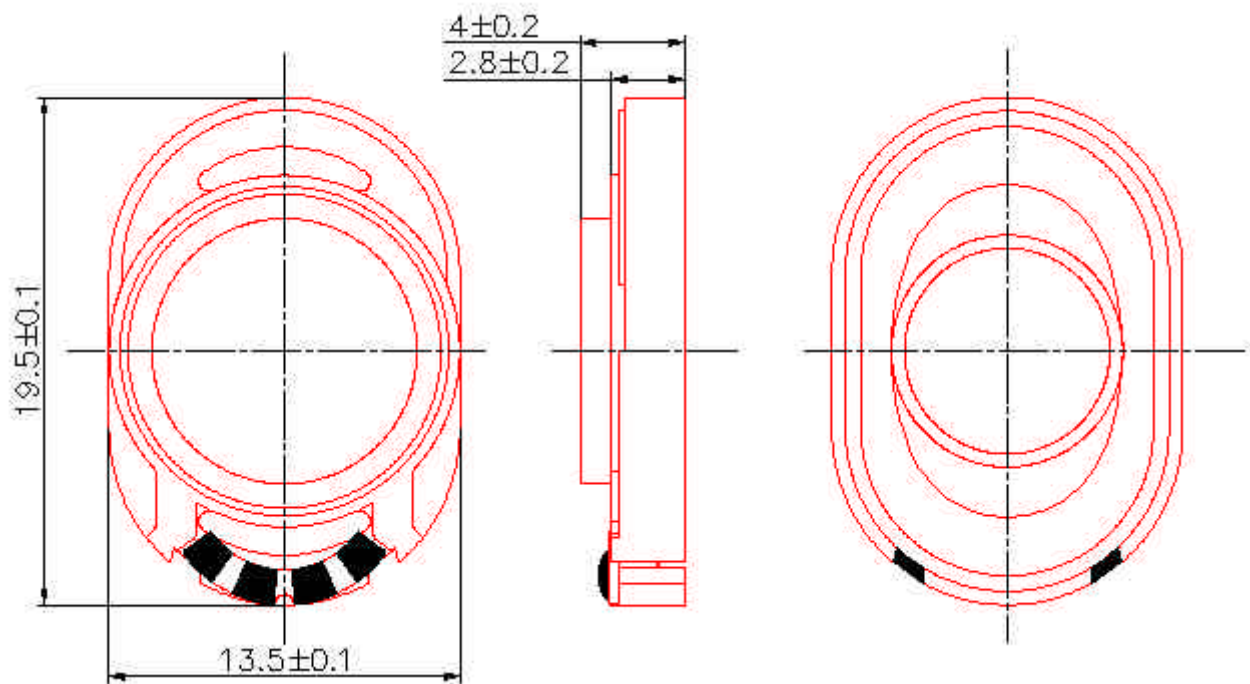
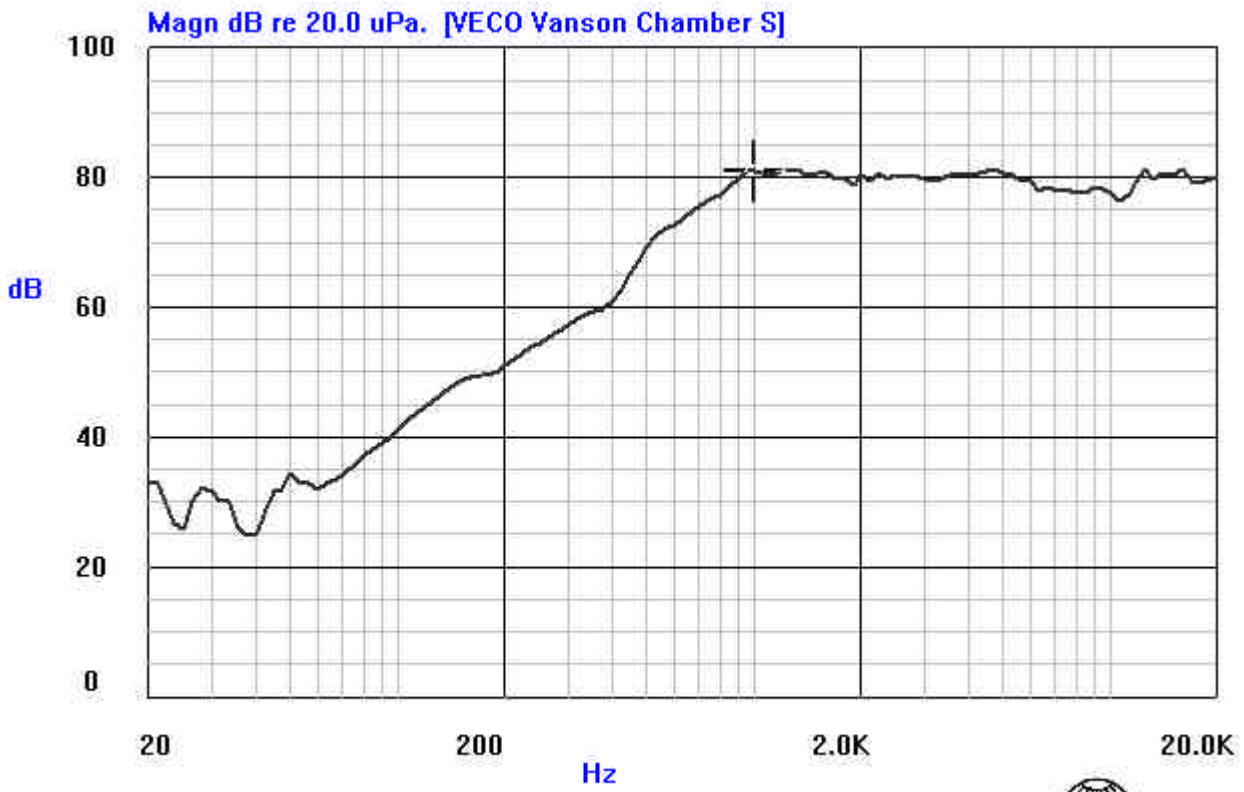

Fig.1

14.Frequency Response Curve.

14.1 Speaker

Sound Pressure Level(SPL) : $80 \pm 3\text{dB}$ 1.0W/0.5M at (800,1k,1.2k,1.5k) AV



Current Curve: 0 X: 1000 Hz Y: 81.05 dB
Time[Y/M/D H:M:S]: 2004/ 7/10 6:44:13



INPUT: 1.0W
MIC DIST: 0.5M
BAFFLE: IEC6028-5

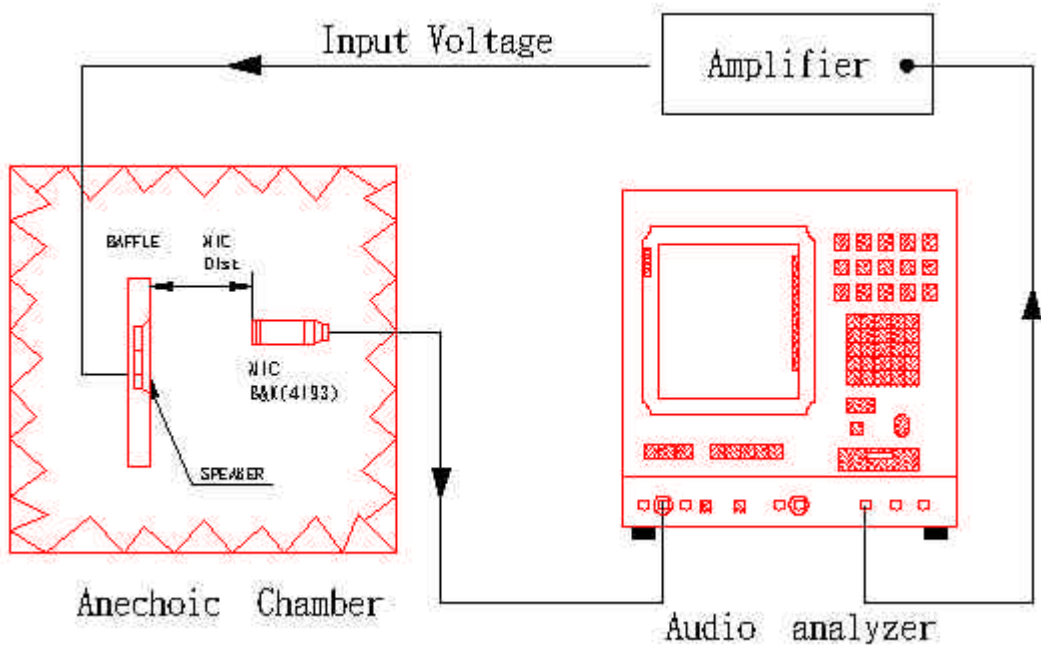

Fig.2

15.Environment Test

15.1 Environment test – High temperature.

After exposure the speaker in the $+ 70 \pm 3$ °C chamber for 24 hours, then leave the speaker at room temperature for 1 hour, the SPL should not deviate by ± 3 db, compare with pre-test measurement.

15.2 Environment test - Low temperature.

After exposure the speaker in the $- 25 \pm 3$ °C chamber for 24 hours, then leave the speaker at room temperature for 1 hour, the SPL should not deviate by ± 3 db, compare with pre-test measurement.

15.3 Environment test-Temperature cycle.

After exposure the speaker in the chamber, temperature cycle setting as below shows, SPL should not deviate by ± 4 db,compare with pre-test measurement.

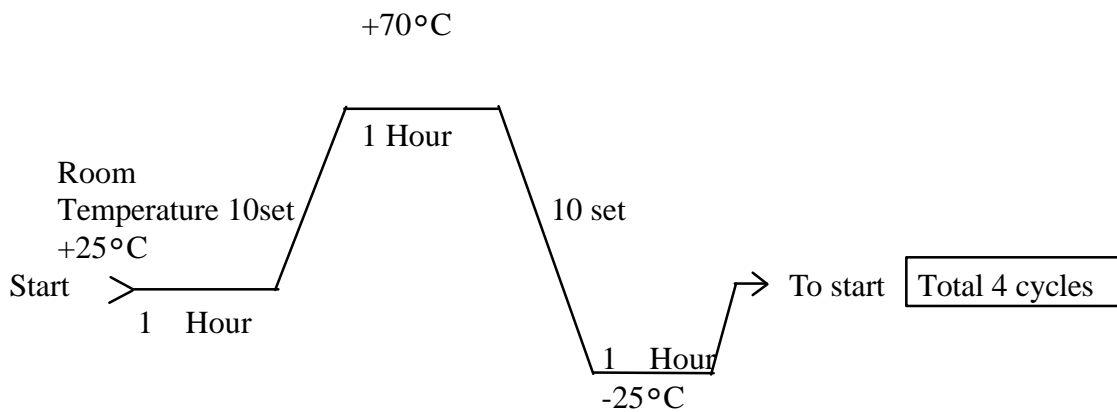

15.4 Environment test – Humidity.

After exposure the speaker in the $+ 40 \pm 3$, relative humidity 90% ~95% chamber for 24 hours, then leave the speaker at room temperature for 6 hours, the SPL should not deviate by ± 3 db, compare with pre-test measurement.

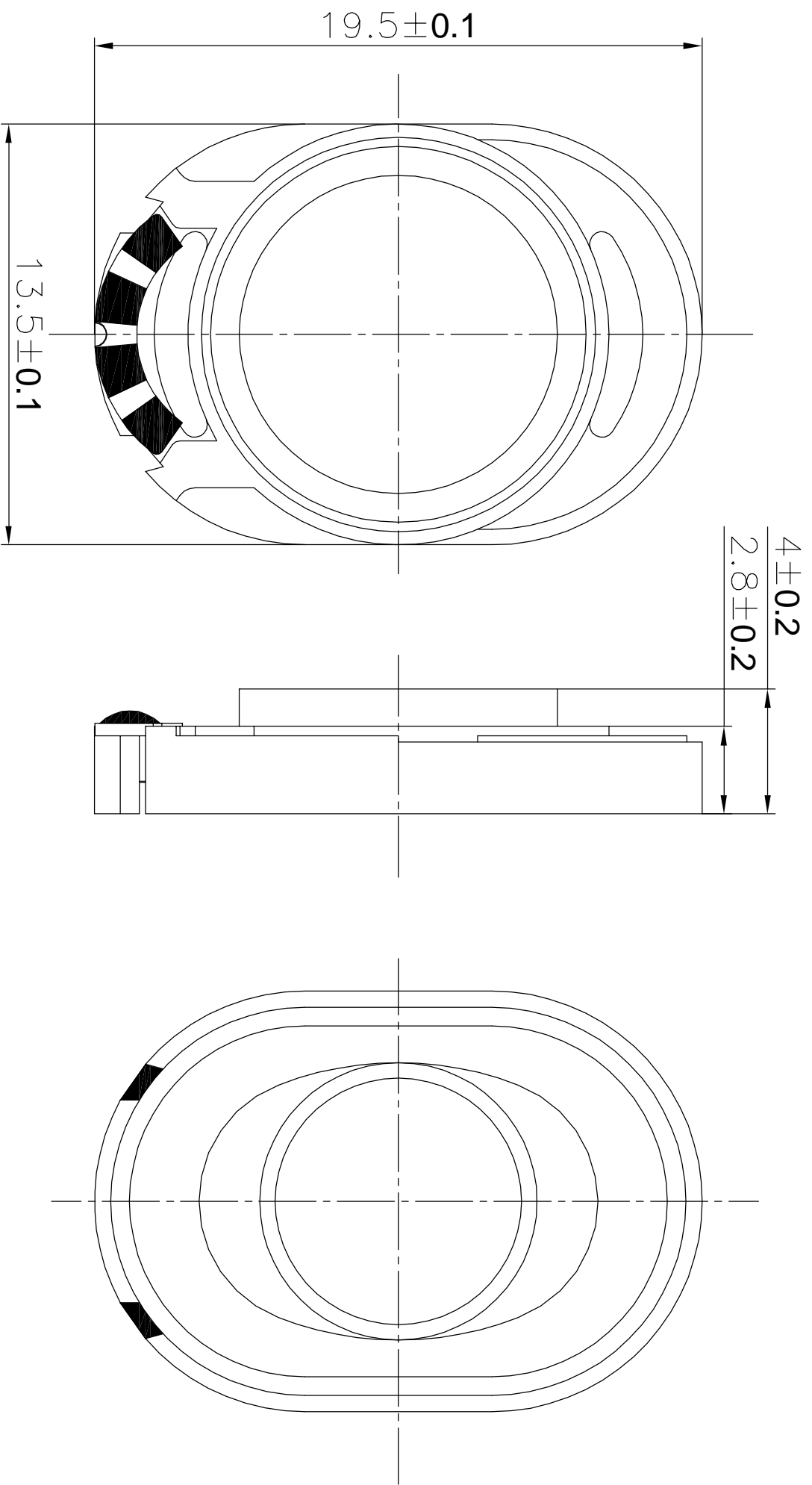

Vansonic Enterprise CO.,Ltd.
 統立企業
 E-MAIL: VANSONIC@MS4.HINET.NET
 TEL: +886-2-29626335 FAX: +886-2-29625220

Title: ASM20V SPL

VERSION	DATE	DESCRIPTION
V 1.1	04.04.12	框體更改為完全跑道形
V 1.0	04.03.24	

Unit: mm Scale: Appr.:
 Tol.: ± 0.02 CHK.: Dwg.:

