

CONFIDENTIAL

VERTRAULICH

Alle Rechte bei Marquardt, auch fuer den Fall von Schutzrechtsanmeldungen. Jede Veruegungsbefugnis, wie Kopier- und Weitergaberecht, bei uns.

THIS DRAWING IS THE EXCLUSIVE PROPERTY OF MARQUARDT. WITHOUT THEIR CONSENT IT MAY NOT BE REPRODUCED OR GIVEN TO THIRD PARTIES.

A	recommended cut-out for snap-in fixing (edge opposite to snap-in direction)	1	2	3	4
			wall thickness	length of cut-out	width of cut-out
		0.75 to 1.25	19.2-0.1	12.9+0.1	
		1.25 to 2	19.4-0.1	12.9+0.1	
		2 to 3	19.8-0.1	12.9+0.1	

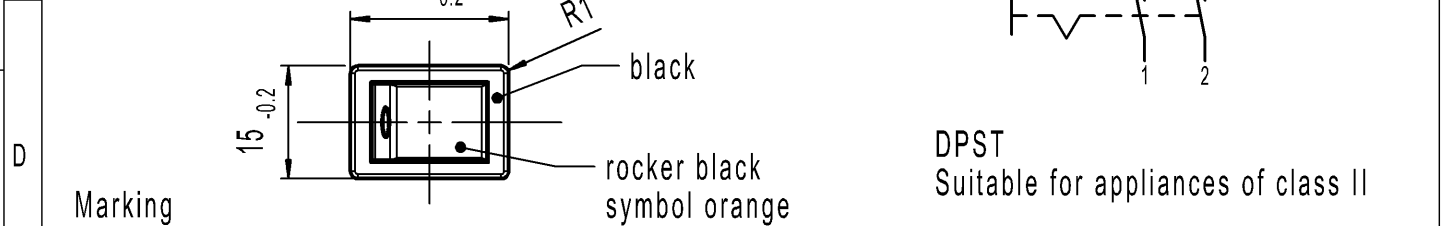
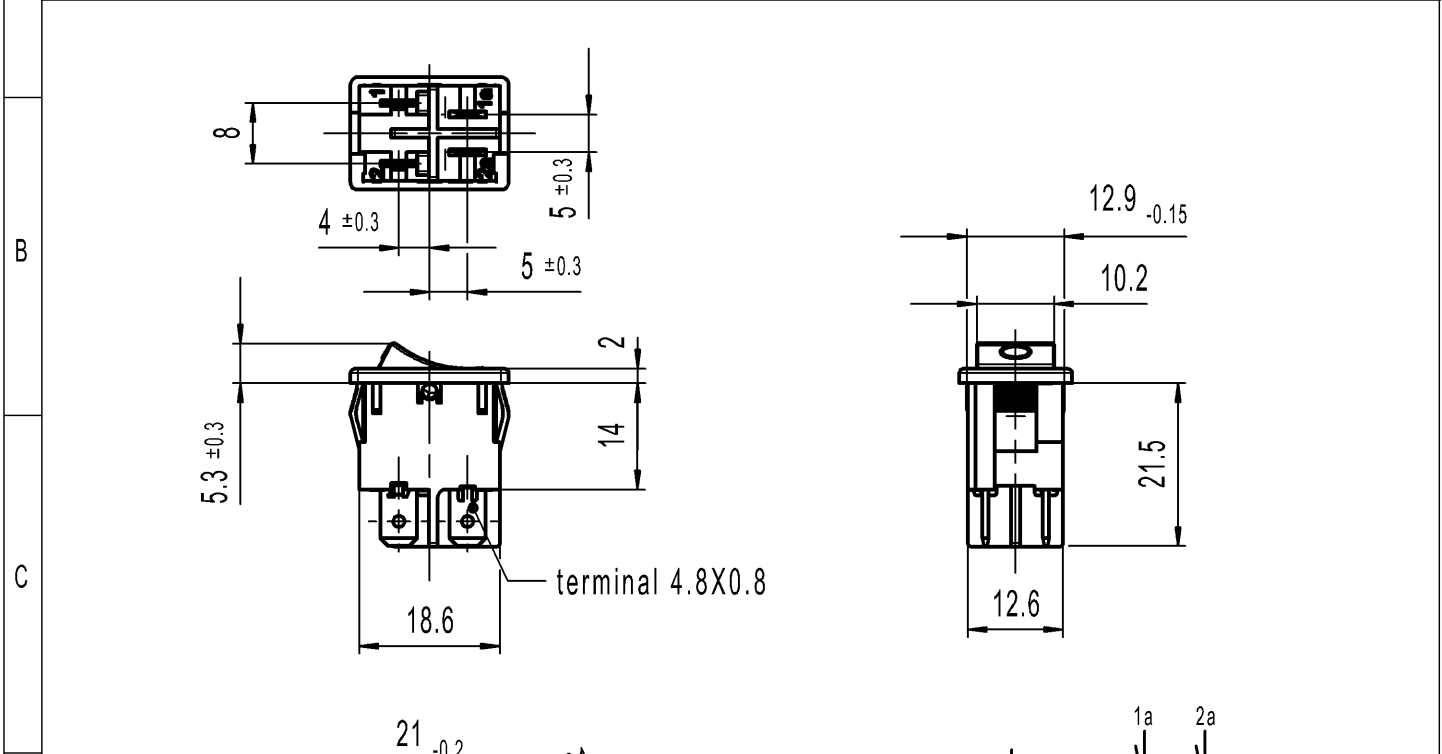

Marking
 1852.
 4(1)/250~T85/55

6A 125V AC
 4A 250V AC
 1/10 HP 125-250V AC
 R52

Code of manufacture: place/year/month

DPST
 Suitable for appliances of class II

-	-	-	1852.1102-XX
Figure	Type	Customer Part No.	Art.No.-PI
Shape and location	Angle $\pm 2^\circ$	Sheet 01	Ident. K
	Edge tolerance	Format DIN A4	Document number 18521102
	Length	Projection	Index g
	Radii	Scale 1:1	Appliance Switch
g	141197	All dimensions are in millimetres	
f	66876	System NX V1899	
e	63303	Replacement of	
d	61657	Zg.gI.Nr.v.16.06.1993	
Index	MEC-No.	Date (YYYY-MM-DD)	Edited by

