

**Asia Pacific**

ChangZhou, China

Tel: +86 519 8981 9713

Email: [sales@amphenol-gec.com](mailto:sales@amphenol-gec.com)

Add: No.11 Fengxiang Road, New District,  
Changzhou, Jiangsu, China

P.C: 213001

GuangZhou, China

Tel: +86 203210 6099

Add: 9th Floor, No.10, the 4th Street, Kehui  
Jingu, Huangpu District, Guangzhou, China

P.C: 510663

**North America**

Winnipeg, Canada

Tel: +1 204 697 2222

Email: [sales@tpil.com](mailto:sales@tpil.com)

Add: 2110 Notre Dame Avenue

Nogales, Mexico

Tel: +52(55) 5258 9984

Add: 482 Mariposa Road Building A,85621

Website: [www.tpil.com](http://www.tpil.com)



# PowerLok™ Connector





## PowerLok™ Receptacle

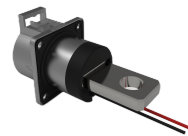

180 Degree Busbar Lug



Thread Pin



Tubular Lug



90 Degree Busbar Lug

Series	180 Degree BusBar Lug						Thread Pin						Tubular Lug						90 Degree Busbar Lug		
	1POS		2POS		3POS		1POS		2POS		3POS		1POS		2POS		3POS		1POS		
	With HVIL	W/O HVIL	With HVIL	W/O HVIL	With HVIL	W/O HVIL	With HVIL	W/O HVIL	With HVIL	W/O HVIL	With HVIL	W/O HVIL	With HVIL	W/O HVIL	With HVIL	W/O HVIL	With HVIL	W/O HVIL	With HVIL	W/O HVIL	
120A	*	*	*	*			*					*									
200A	*	*	*	*			*					*								*	*
300A	*	*	*	*	*	*	*	*	*	*	*	*	*	*	*	*	*	*	*	*	*
500A	*	*					*					*							*	*	

### 180 Degree Busbar Lug Receptacle

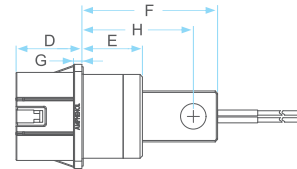
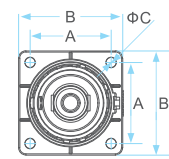
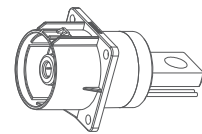

Product	180 Degree Busbar Lug 1POS Dimensions(mm)									
	Series	A	B	C	D	E	F	G	H	
PowerLok™ 1POS 180 Degree Busbar Lug Receptacle	120A	20.0	28.0	Φ3.6	18.0	13.0	31.5	3.0	24.5	
	200A	25.0	33.0	Φ4.2	20.7	19.3	39.5	3.0	32.3	
	300A	27.0	35.0	Φ4.2	20.7	21.3	49.3	3.0	39.3	
	500A	33.5	43.0	Φ4.3	27.2	25.0	56.0	3.5	46.0	

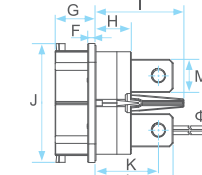
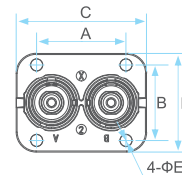
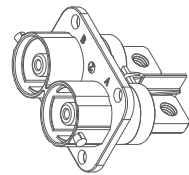

Product	180 Degree Busbar Lug 2POS Dimensions(mm)													
	Series	A	B	C	D	E	F	G	H	I	J	K	L	M
PowerLok™ 2POS 180 Degree Busbar Lug Receptacle	120A	35.0	25.5	48.0	34.0	Φ3.6	3.0	18.5	14.5	29.5	49.0	23.5	33.0	9.8
	300A	45.0	38.0	65.6	49.6	Φ6.2	4.0	22.0	20.0	49.0	65.4	35.0	43.0	18.2

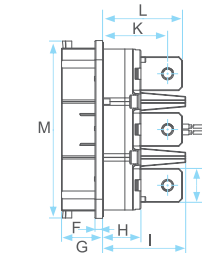
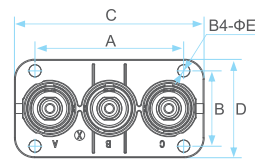
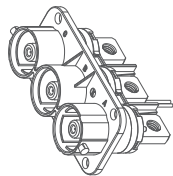

Product	180 Degree Busbar Lug 3POS Dimensions(mm)													
	Series	A	B	C	D	E	F	G	H	I	J	K	L	M
PowerLok™ 3POS 180 Degree Busbar Lug Receptacle	300A	75.0	38.0	95.6	49.6	Φ10.0	4.0	22.0	20.7+1.0	44.7+0.1	18.2	35.0+0.1	43.0+0.1	95.6

### Thread Pin Receptacle

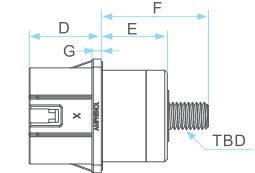
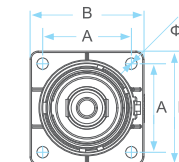
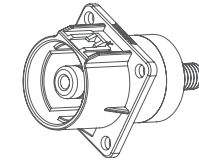

Product	Thread Pin 1POS Dimensions(mm)							
	Series	A	B	C	D	E	F	G
PowerLok™ 1POS Thread Pin Receptacle	120A	20.0	28.0	Φ3.6	18.0	13.0	32.0	3.0
	300A	27.0	35.0	Φ4.2	20.7	21.3	38.1	3.0
	500A	33.5	43.0	Φ4.3	27.2	25.0	40.5	3.5

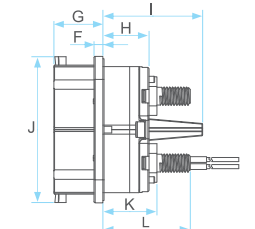
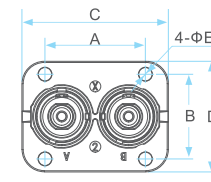
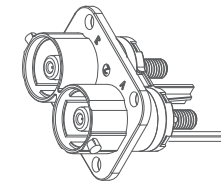

Product	Thread Pin 2POS Dimensions(mm)													
	Series	A	B	C	D	E	F	G	H	I	J	K	L	
PowerLok™ 2POS Thread Pin Receptacle	300A	45.0	38.0	65.6	49.6	Φ6.2	4.0	22.0	20.7±0.1	44.7±0.1	65.4	24.2±0.1	39.2±0.1	

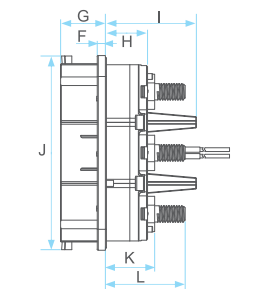
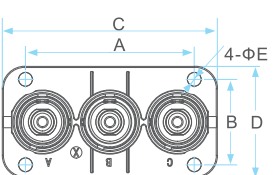
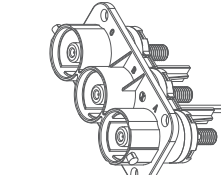

Product	Thread Pin 3POS Dimensions(mm)													
	Series	A	B	C	D	E	F	G	H	I	J	K	L	
PowerLok™ 3POS Thread Pin Receptacle	300A	75.0	38.0	95.6	49.6	Φ6.2	4.0	22.0	20.7±0.1	44.7±0.1	95.1	24.2±0.1	39.2±0.1	

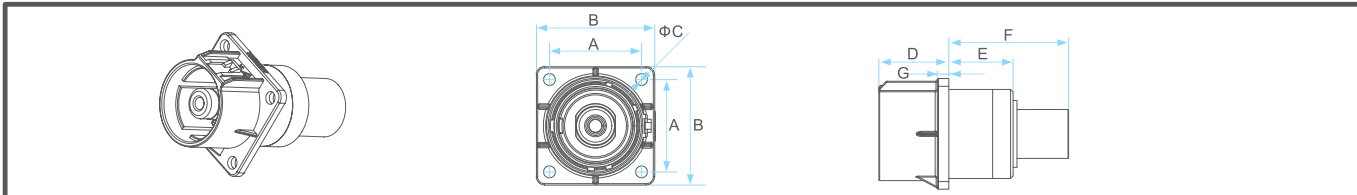

Product	Tubular Lug 1POS Dimensions(mm)							
	Series	A	B	C	D	E	F	G
PowerLok™ 1POS Tubular Lug Receptacle	120A	20.0	28.0	φ3.6	18.0	13.0	27.5	3.0
	300A	27.0	35.0	φ4.2	20.7	21.3	TBD	3.0
	500A	33.5	43.0	φ4.3	27.2	25.0	46.5	4.5

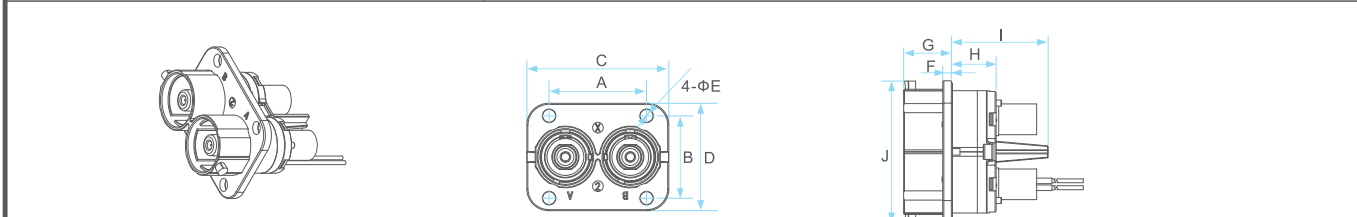

Product	Tubular Lug 2POS Dimensions(mm)										
	Series	A	B	C	D	E	F	G	H	I	J
PowerLok™ 2POS Tubular Lug Receptacle	300A	45.0	38.0	65.6	49.6	φ6.2	4.0	22.0	20.7	44.7	65.4

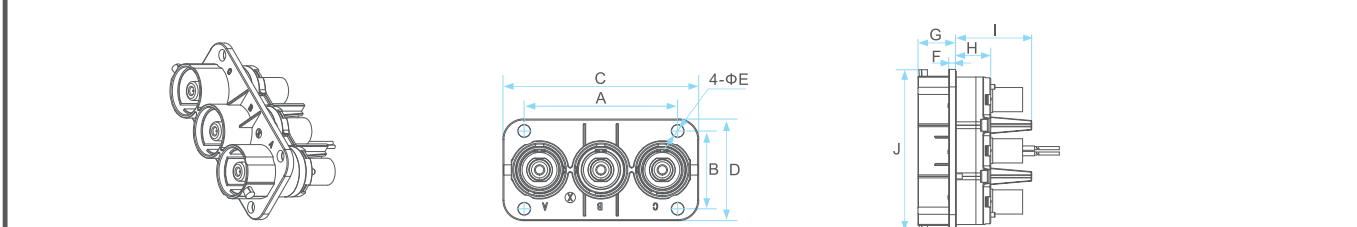

Product	Tubular Lug 3POS Dimensions(mm)										
	Series	A	B	C	D	E	F	G	H	I	J
PowerLok™ 3POS Tubular Lug Receptacle	300A	75.0	38.0	95.6	49.6	φ6.2	4.0	22.0	20.7	44.7	95.1

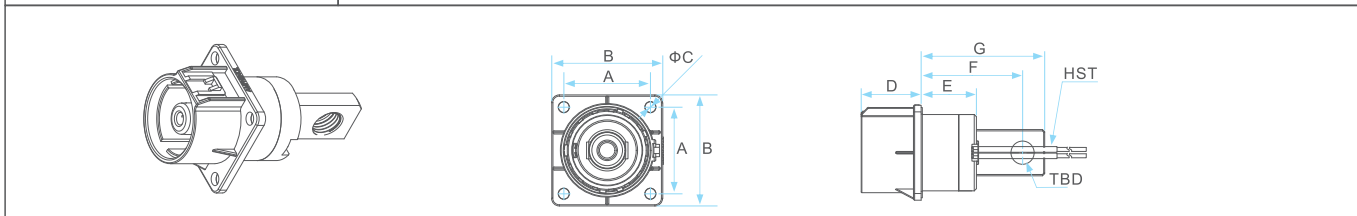

Product	90 Degree Busbar 1POS Dimensions(mm)								
	Series	A	B	C	D	E	F	G	H
PowerLok™ 1POS 90 Degree Busbar Receptacle	300A	27.0	35.0	φ4.2	20.7	24.1	49.3	3.0	39.3
	500A	33.5	43.0	φ4.3	20.7	25.0	56.0	3.5	46.0

### PowerLok™ Plug

Series	1POS				2POS				3POS			
	Assembly		Overmolded		Assembly		Overmolded		Assembly		Overmolded	
	Straight	Right Angle	Straight	Right Angle	Straight	Right Angle	Straight	Right Angle	Straight	Right Angle	Straight	Right Angle
120A			*	*			*	*				
200A	*	*										
300A	*	*	*	*	*	*			*	*		
500A	*	*	*	*								

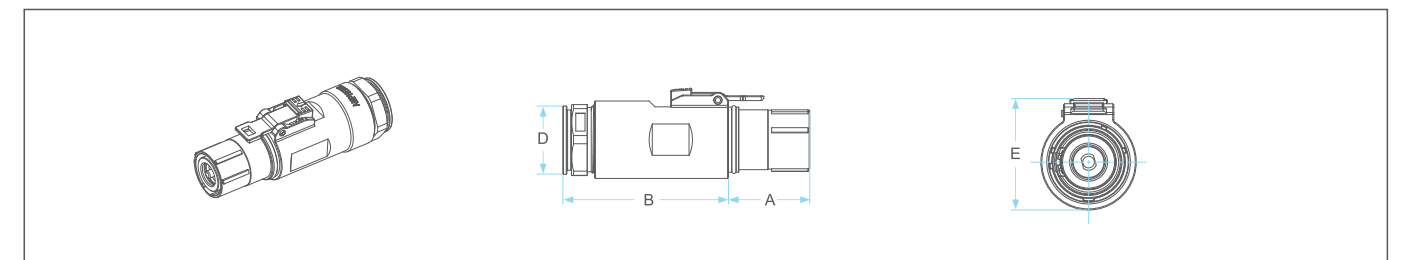

Product	1POS Straight Assembly Plug Dimensions(mm)				
	Series	A	B	D	E(REF)
PowerLok™ 1POS Straight Assembly Plug	200A	29.8	54.3	φ25.9	30.9
	300A	31.0	63.1	φ29.5	34.4
	500A	41.1	77.0	φ39.0	43.5

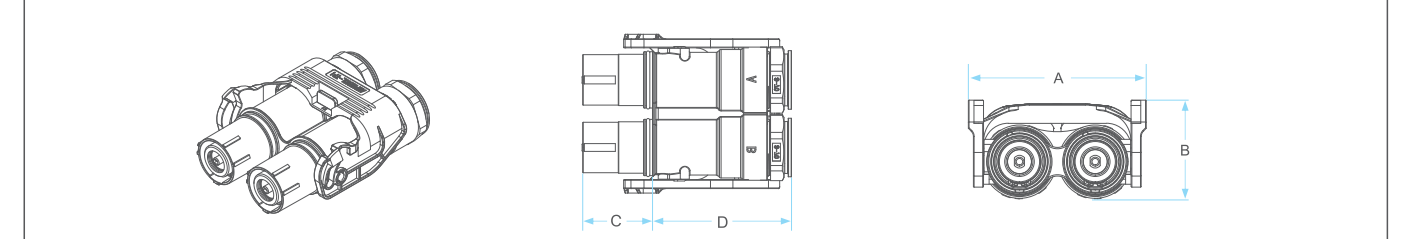

Product	2POS Straight Assembly Plug Dimensions(mm)				
	Series	A	B	C	D
PowerLok™ 2POS Straight Assembly Plug	300A	70.5	38.8	31.0	59.6

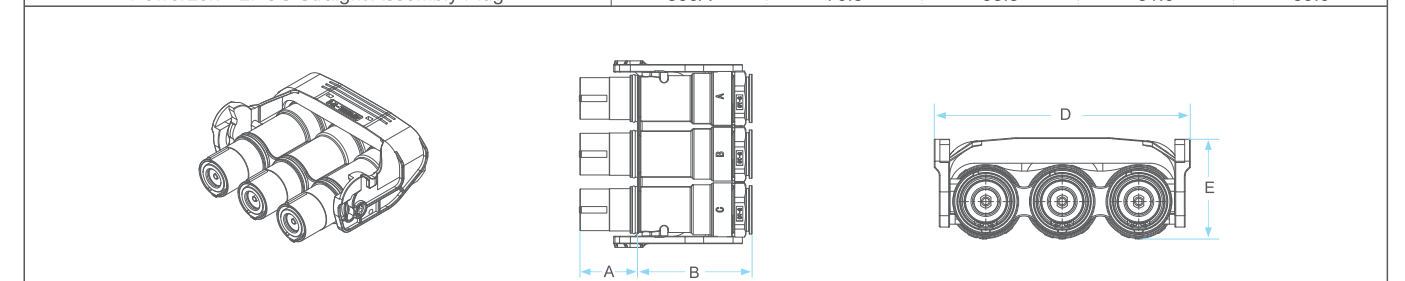

Product	3POS Straight Assembly Plug Dimensions(mm)				
	Series	A	B	D	E
PowerLok™ 3POS Straight Assembly Plug	300A	31.0	59.6	100.5	38.0



**Right Angle Assembly Plug**

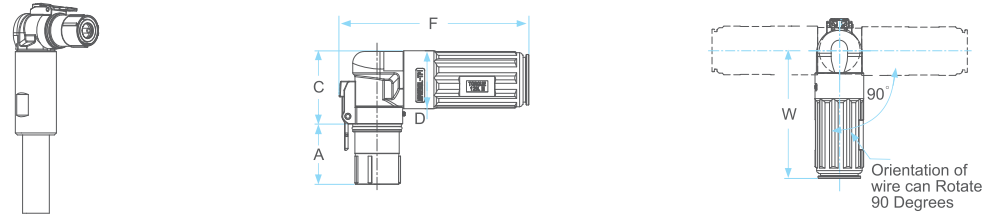

Product	1POS Right Angle Assembly Plug Dimensions(mm)					
	Series	A	C	D	F(REF)	W
PowerLok™ 1POS Right Angle Assembly Plug	200A	29.8	34.7	Φ25.9	93.5	75.6
	300A	31.0	37.6	Φ29.5	97.7	78.1
	500A	41.1	47.7	Φ38.2	118.1	93.7

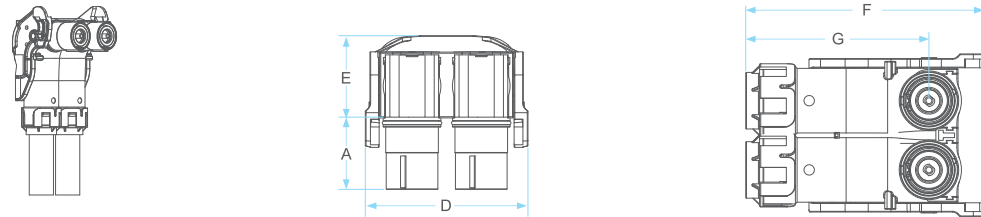

Product	2POS Right Angle Assembly Plug Dimensions(mm)					
	Series	A	D	E	F	G
PowerLok™ 2POS Right Angle Assembly Plug	300A	31.0	70.5	34.8	103.3	79.4

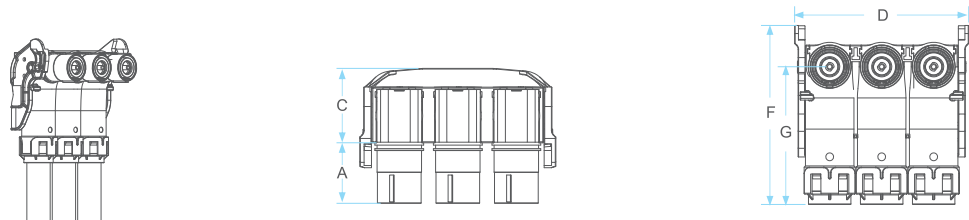

Product	3POS Right Angle Assembly Plug Dimensions(mm)					
	Series	A	C	D	F	G
PowerLok™ 3POS Right Angle Assembly Plug	300A	31.0	38.0	100.5	103.3	79.4

**Note**

Amphenol TPI can provide customized solutions based on customer's installation space. If you need to order or ask questions, please contact your sales representative for additional information!

**Straight Overmolded Plug**

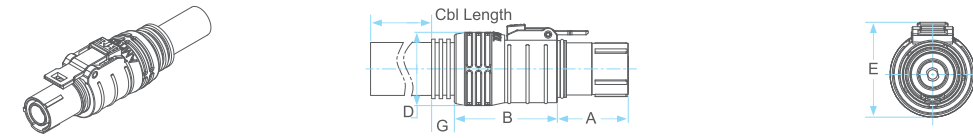

Product	1POS Straight Overmolded Plug Dimensions(mm)					
	Series	A	B	D	E	G
PowerLok™ 1POS Straight Overmolded Plug	120A	22.5	39.0	Φ24.6	28.5	9.9
	300A	31.0	45.0	Φ32.0	35.6	9.9
	500A	41.1	52.0	Φ42.0	43.6	9.9

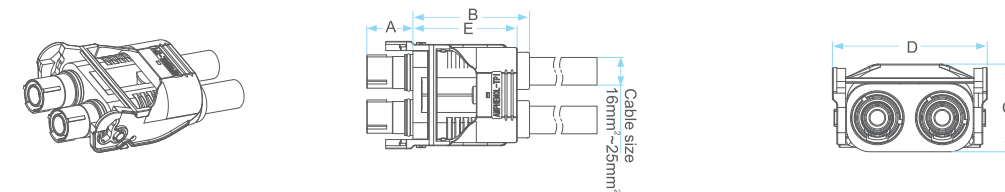

Product	2POS Straight Overmolded Plug Dimensions(mm)					
	Series	A	B	C	D	E
PowerLok™ 2POS Straight Overmolded Plug	120A	22.5	57.0	29.7	52.5	51.0

**Right Angle Overmolded Plug**

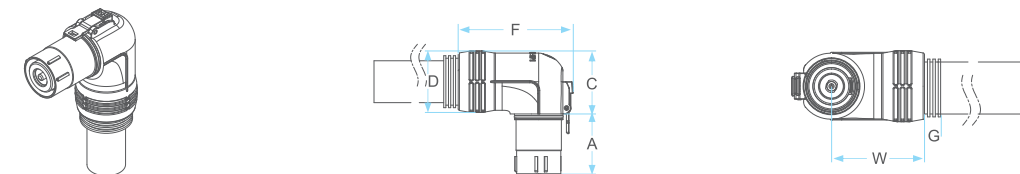

Product	1POS Right Angle Overmolded Plug Dimensions(mm)						
	Series	A	C	D	F(PEF)	W	G
PowerLok™ 1POS Right Angle Overmolded Plug	120A	22.5	25.3	Φ24.6	55.8	40.0	9.9
	300A	31.0	32.5	Φ32.0	69.6	50.0	9.9
	500A	41.1	43.0	Φ42.0	78.6	55.0	9.9

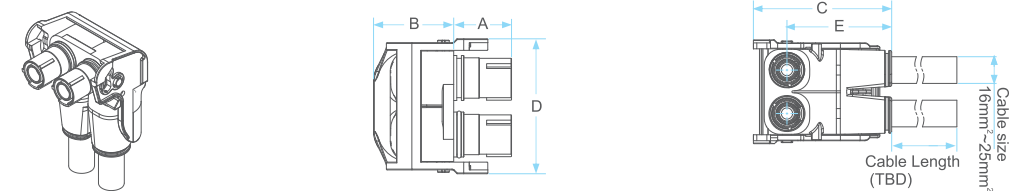

Product	2POS Right Angle Overmolded Plug Dimensions(mm)					
	Series	A	B	C	D	E
PowerLok™ 2POS Right Angle Overmolded Plug	120A	22.5	31.2	70.0	52.5	53.0

### PowerLok™ Connector Key Map

**1POS-120A**

M direction schematic

---

**1POS-200A**

M direction schematic

---

**1POS-300A**

M direction schematic

---

**1POS-500A (Assembly)**

M direction schematic

---

**1POS-500A (Overmolded)**

M direction schematic

**2POS-120A**

M direction schematic

---

**2POS-300A**

M direction schematic

---

**3POS-300A**

M direction schematic



### PowerLok™ Terminal

#### 300A 1POS&2POS&3POS Straight

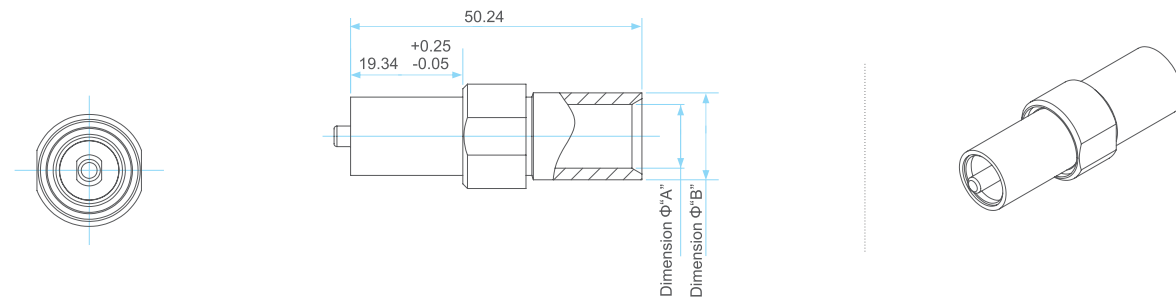

Part Number	Dimension "A"	Dimension "B"	Cable Size
AC-CP001017	7.50	10.00	25mm <sup>2</sup>
AC-CP000872	8.80	11.80	35mm <sup>2</sup>
AC-CP000689	9.00	12.00	35mm <sup>2</sup>
AC-CP001018	10.30	14.50	50mm <sup>2</sup>
AC-CP000876	11.00	15.00	50mm <sup>2</sup>
AC-CP000871	12.50	16.50	70mm <sup>2</sup>
AC-CP000878	12.50	16.80	70mm <sup>2</sup>

#### 300A 2POS&3POS Right Angle

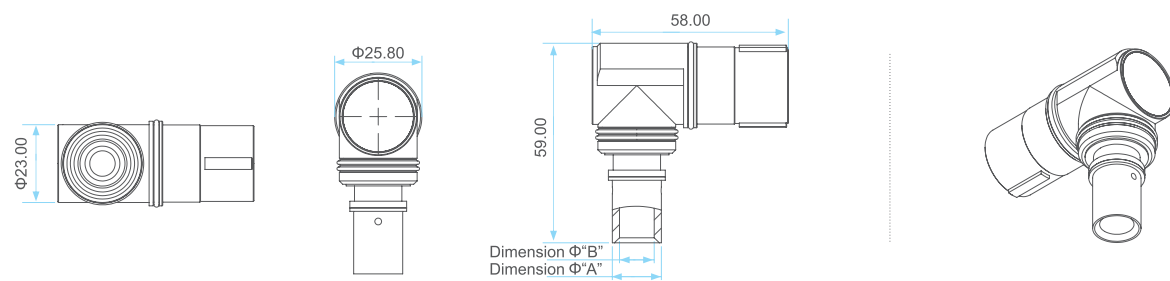

Part Number	Dimension "A"	Dimension "B"	Cable Size
AC-CP000994	14.5	10.3	50mm <sup>2</sup>
AC-CP000995	14.5	10.3	50mm <sup>2</sup>
AC-CP000996	16.5	12.5	70mm <sup>2</sup>

### Ordering Information-PowerLok™ 1POS Receptacle W/O HVIL

PL 00 X - 300 - 10 M10

Product Type	Connector Type	Key (Touch Proof Cover Color)	Current & HVIL		Termination Type		Termination Size
PowerLok™	00 1POS Receptacle	X Orange	120	120A W/O HVIL	10	180 Degree Busbar Lug	D <sup>(1)</sup> +Stud Size
		Y Black	200	200A W/O HVIL	20	Thread Pin	M <sup>(2)</sup> +Stud Size
		U Yellow	300	300A W/O HVIL	30	Tubular Lug	D+Cable Size
		V Green	500	500A W/O HVIL	90	90 Degree Busbar Lug	D+Stud Size
		W Red					M+Stud Size
T Blue							

W/O HVIL													
Series	Key	Busbar Lug(D+Stud Size)			Busbar Lug(M+Stud Size)			Thread Pin(M+Thread Size)			Tubular Lug(D+Cable Size)		
		Termination	Description	Part Number	Termination	Description	Part Number	Termination	Description	Part Number	Termination	Description	Part Number
120A	X	D6	PL00X-120-10D6	AC-HA000469	M6	PL00X-120-10M6	AC-HA000479	M6	PL00X-120-20M6	AC-HA000563	D25	PL00X-120-30D25	AC-HA001813
	Y		PL00Y-120-10D6	AC-HA000470		PL00Y-120-10M6	AC-HA000480		PL00Y-120-20M6	AC-HA000564		PL00Y-120-30D25	AC-HA001814
	U		PL00U-120-10D6	AC-HA000471		PL00U-120-10M6	AC-HA000481		PL00U-120-20M6	AC-HA000565		PL00U-120-30D25	AC-HA001815
	V		PL00V-120-10D6	AC-HA000472		PL00V-120-10M6	AC-HA000482		PL00V-120-20M6	AC-HA000566		PL00V-120-30D25	AC-HA001816
	W		PL00W-120-10D6	AC-HA000473		PL00W-120-10M6	AC-HA000483		PL00W-120-20M6	AC-HA000567		PL00W-120-30D25	AC-HA001817
200A	X		-	-	M6	PL00X-200-10M6	PL00X-200-10M6	-	-	-	-	-	-
	Y		-	-		PL00Y-200-10M6	PL00Y-200-10M6	-	-	-	-	-	-
	U		-	-		PL00U-200-10M6	PL00U-200-10M6	-	-	-	-	-	-
	V		-	-		PL00V-200-10M6	PL00V-200-10M6	-	-	-	-	-	-
	W		-	-		PL00W-200-10M6	PL00W-200-10M6	-	-	-	-	-	-
300A	X	D6	PL00X-300-10D6	AC-HA0003928	M6	PL00X-300-10M6	AC-HA0003922	M6	PL00X-300-20M6	AC-HA000596	D35	PL00X-300-30D35	AC-HA001454
	Y		PL00Y-300-10D6	AC-HA0003929		PL00Y-300-10M6	AC-HA0003923		PL00Y-300-20M6	AC-HA000597		PL00Y-300-30D35	AC-HA001455
	U		PL00U-300-10D6	AC-HA0003930		PL00U-300-10M6	AC-HA0003924		PL00U-300-20M6	AC-HA000598		PL00U-300-30D35	AC-HA001456
	V		PL00V-300-10D6	AC-HA0003931		PL00V-300-10M6	AC-HA0003925		PL00V-300-20M6	AC-HA000599		PL00V-300-30D35	AC-HA001457
	W		PL00W-300-10D6	AC-HA0003932		PL00W-300-10M6	AC-HA0003926		PL00W-300-20M6	AC-HA000600		PL00W-300-30D35	AC-HA001458
500A	X	D8	PL00X-500-10D8	AC-HA0002182	M8	PL00X-500-10M8	AC-HA0002511	M8	PL00X-500-20M8	AC-HA000578	D95	PL00X-500-30D95	AC-HA011391
	Y		PL00Y-500-10D8	AC-HA0002183		PL00Y-500-10M8	AC-HA0002512		PL00Y-500-20M8	AC-HA000579		PL00Y-500-30D95	AC-HA011392
	U		PL00U-500-10D8	AC-HA000556		PL00U-500-10M8	AC-HA0002513		PL00U-500-20M8	AC-HA000580		PL00U-500-30D95	AC-HA011393
	V		PL00V-500-10D8	AC-HA000557		PL00V-500-10M8	AC-HA0002514		PL00V-500-20M8	AC-HA000581		PL00V-500-30D95	AC-HA011394
	W		PL00W-500-10D8	AC-HA000558		PL00W-500-10M8	AC-HA0002515		PL00W-500-20M8	AC-HA000582		PL00W-500-30D95	AC-HA011395

(1) D=Through hole ; (2) M=Screw hole

### Ordering Information-PowerLok™ 1POS Receptacle W/O HVIL (90 Degree Busbar Lug)

Product Type		Connector Type		Key (Touch Proof Cover Color)		Current & HVIL		Termination Type		Termination Size	
PowerLok™	00	1POS Receptacle	X	Orange	300	300A W/O HVIL	90	90 Degree			D+Stud Size
			Y	Black							M+Stud Size
			U	Yellow							
			V	Green							
			W	Red							
			T	Blue							

Continued W/O HVIL

Series Key	90D Busbar Lug+(D+Stud Size)				90D Busbar Lug+(M+Stud Size)			
	Termination	Description	Part Number	Termination	Description	Part Number	Termination	Description
300A	D6	X	PL00X-300-90D6	AC-HA004032	M6	X	PL00X-300-90M6	AC-HA004050
		Y	PL00Y-300-90D6	AC-HA004033		Y	PL00Y-300-90M6	AC-HA004051
		U	PL00U-300-90D6	AC-HA004034		U	PL00U-300-90M6	AC-HA004052
		V	PL00V-300-90D6	AC-HA004035		V	PL00V-300-90M6	AC-HA004053
		W	PL00W-300-90D6	AC-HA004036		W	PL00W-300-90M6	AC-HA004054
		T	PL00T-300-90D6	AC-HA004037		T	PL00T-300-90M6	AC-HA004055
	D8	X	PL00X-300-90D8	AC-HA004026	M8	X	PL00X-300-90M8	AC-HA004044
		Y	PL00Y-300-90D8	AC-HA004027		Y	PL00Y-300-90M8	AC-HA004045
		U	PL00U-300-90D8	AC-HA004028		U	PL00U-300-90M8	AC-HA004046
		V	PL00V-300-90D8	AC-HA004029		V	PL00V-300-90M8	AC-HA004047
		W	PL00W-300-90D8	AC-HA004030		W	PL00W-300-90M8	AC-HA004048
		T	PL00T-300-90D8	AC-HA004031		T	PL00T-300-90M8	AC-HA004049
D10	X	PL00X-300-90D10	AC-HA004020	M10	X	PL00X-300-90M10	AC-HA004038	
	Y	PL00Y-300-90D10	AC-HA004021		Y	PL00Y-300-90M10	AC-HA004039	
	U	PL00U-300-90D10	AC-HA004022		U	PL00U-300-90M10	AC-HA004040	
	V	PL00V-300-90D10	AC-HA004023		V	PL00V-300-90M10	AC-HA004041	
	W	PL00W-300-90D10	AC-HA004024		W	PL00W-300-90M10	AC-HA004042	
	T	PL00T-300-90D10	AC-HA004025		T	PL00T-300-90M10	AC-HA004043	
500A	D8	X	PL00X-500-90D8	AC-HA007831	M8	X	PL00X-500-90M8	AC-HA007836
		Y	PL00Y-500-90D8	AC-HA007832		Y	PL00Y-500-90M8	AC-HA007837
		U	PL00U-500-90D8	AC-HA007833		U	PL00U-500-90M8	AC-HA007838
		V	PL00V-500-90D8	AC-HA007834		V	PL00V-500-90M8	AC-HA007839
		W	PL00W-500-90D8	AC-HA007835		W	PL00W-500-90M8	AC-HA007840
		T	PL00T-500-90D8	AC-HA007841		T	PL00T-500-90M8	AC-HA007846
	D10	X	PL00X-500-90D10	AC-HA007842	M10	X	PL00X-500-90M10	AC-HA007847
		Y	PL00Y-500-90D10	AC-HA007843		Y	PL00Y-500-90M10	AC-HA007848
		U	PL00U-500-90D10	AC-HA007844		U	PL00U-500-90M10	AC-HA007849
		V	PL00V-500-90D10	AC-HA007845		V	PL00V-500-90M10	AC-HA007850
		W	PL00W-500-90D10	AC-HA007846		W	PL00W-500-90M10	AC-HA007851
		T	PL00T-500-90D10	AC-HA007847		T	PL00T-500-90M10	AC-HA007852

### Ordering Information-PowerLok™ 1POS Receptacle With HVIL

Product Type		Connector Type		Key (Touch Proof Cover Color)		Current & HVIL		Termination Type		Termination Size	
PowerLok™	00	1POS Receptacle	X	Orange	121	120A With HVIL	10	180 Degree Busbar Lug			D + Stud Size
			Y	Black							M + Stud Size
			U	Yellow							
			V	Green							
			W	Red							
			T	Blue							

With HVIL

Series Key	Busbar Lug(D+Stud Size)				Busbar Lug(M+Stud Size)				90D Busbar Lug+(D+Stud Size)				90D Busbar Lug+(M+Stud Size)			
	Termination	Description	Part Number	Termination	Description	Part Number	Termination	Description	Part Number	Termination	Description	Part Number	Termination	Description	Part Number	
120A	D6	X	PL00X-121-10D6	AC-HA000305	M6	X	PL00X-121-10M6	AC-HA000459	D6	X	PL00X-121-10D6	EX-HA000645	M6	X	PL00X-121-10M6	EX-HA000659
		Y	PL00Y-121-10D6	AC-HA000306		Y	PL00Y-121-10M6	AC-HA000460		Y	PL00Y-121-10D6	EX-HA000646		Y	PL00Y-121-10M6	EX-HA000660
		U	PL00U-121-10D6	AC-HA000307		U	PL00U-121-10M6	AC-HA000461		U	PL00U-121-10D6	EX-HA000647		U	PL00U-121-10M6	EX-HA000661
		V	PL00V-121-10D6	AC-HA000308		V	PL00V-121-10M6	AC-HA000462		V	PL00V-121-10D6	EX-HA000648		V	PL00V-121-10M6	EX-HA000662
		W	PL00W-121-10D6	AC-HA000309		W	PL00W-121-10M6	AC-HA000463		W	PL00W-121-10D6	EX-HA000649		W	PL00W-121-10M6	EX-HA000663
		T	PL00T-121-10D6	AC-HA000310		T	PL00T-121-10M6	AC-HA000464		T	PL00T-121-10D6	EX-HA000650		T	PL00T-121-10M6	EX-HA000664
200A	D8	X	PL00X-201-10D8	AC-HA004320	M8	X	PL00X-201-10M8	AC-HA004321	D8	X	PL00X-201-10D8	EX-HA000639	M8	X	PL00X-201-10M8	EX-HA000649
		Y	PL00Y-201-10D8	AC-HA004321		Y	PL00Y-201-10M8	AC-HA004322		Y	PL00Y-201-10D8	EX-HA000640		Y	PL00Y-201-10M8	EX-HA000650
		U	PL00U-201-10D8	AC-HA004322		U	PL00U-201-10M8	AC-HA004323		U	PL00U-201-10D8	EX-HA000641		U	PL00U-201-10M8	EX-HA000651
		V	PL00V-201-10D8	AC-HA004323		V	PL00V-201-10M8	AC-HA004324		V	PL00V-201-10D8	EX-HA000642		V	PL00V-201-10M8	EX-HA000652
		W	PL00W-201-10D8	AC-HA004324		W	PL00W-201-10M8	AC-HA004325		W	PL00W-201-10D8	EX-HA000643		W	PL00W-201-10M8	EX-HA000653
		T	PL00T-201-10D8	AC-HA004325		T	PL00T-201-10M8	AC-HA004326		T	PL00T-201-10D8	EX-HA000644		T	PL00T-201-10M8	EX-HA000654
300A	D6	X	PL00X-301-10D6	AC-HA003940	M6	X	PL00X-301-10M6	AC-HA003934	D6	X	PL00X-301-10D6	EX-HA000645	M6	X	PL00X-301-10M6	EX-HA000659
		Y	PL00Y-301-10D6	AC-HA003941		Y	PL00Y-301-10M6	AC-HA003935		Y	PL00Y-301-10D6	EX-HA000646		Y	PL00Y-301-10M6	EX-HA000660
		U	PL00U-301-10D6	AC-HA003942		U	PL00U-301-10M6	AC-HA003936		U	PL00U-301-10D6	EX-HA000647		U	PL00U-301-10M6	EX-HA000661
		V	PL00V-301-10D6	AC-HA003943		V	PL00V-301-10M6	AC-HA003937		V	PL00V-301-10D6	EX-HA000648		V	PL00V-301-10M6	EX-HA000662
		W	PL00W-301-10D6	AC-HA003944		W	PL00W-301-10M6	AC-HA003938		W	PL00W-301-10D6	EX-HA000649		W	PL00W-301-10M6	EX-HA000663
		T	PL00T-301-10D6	AC-HA003945		T	PL00T-301-10M6	AC-HA003939		T	PL00T-301-10D6	EX-HA000650		T	PL00T-301-10M6	EX-HA000664
	D8	X	PL00X-301-10D8	AC-HA001088	M8	X	PL00X-301-10M8	AC-HA001976	D8	X	PL00X-301-10D8	EX-HA000639	M8	X	PL00X-301-10M8	EX-HA000649
		Y	PL00Y-301-10D8	AC-HA001089		Y	PL00Y-301-10M8	AC-HA001977		Y	PL00Y-301-10D8	EX-HA000640		Y	PL00Y-301-10M8	EX-HA000650
		U	PL00U-301-10D8	AC-HA001090		U	PL00U-301-10M8	AC-HA001978		U	PL00U-301-10D8	EX-HA000641		U	PL00U-301-10M8	EX-HA000651
		V	PL00V-301-10D8	AC-HA001091		V	PL00V-301-10M8	AC-HA001979		V	PL00V-301-10D8	EX-HA000642		V	PL00V-301-10M8	EX-HA000652
		W	PL00W-301-10D8	AC-HA001092		W	PL00W-301-10M8	AC-HA001980		W	PL00W-301-10D8	EX-HA000643		W	PL00W-301-10M8	EX-HA000653
		T	PL00T-301-10D8	AC-HA001388		T	PL00T-301-10M8	AC-HA001981		T	PL00T-301-10D8	EX-HA000644		T	PL00T-301-10M8	EX-HA000654
500A	D10	X	PL00X-301-10D10	AC-HA000454	M10	X	PL00X-301-10M10	AC-HA000300	D10	X	PL00X-301-10D10	EX-HA000634	M10	X	PL00X-301-10M10	EX-HA000654
		Y	PL00Y-301-10D10	AC-HA000455		Y	PL00Y-301-10M10	AC-HA000301		Y	PL00Y-301-10D10	EX-HA000635		Y	PL00Y-301-10M10	EX-HA000655
		U	PL00U-301-10D10	AC-HA000456		U	PL00U-301-10M10	AC-HA000302		U	PL00U-301-10D10	EX-HA000636		U	PL00U-301-10M10	EX-HA000656
		V	PL00V-301-10D10	AC-HA000457		V	PL00V-301-10M10	AC-HA000303		V	PL00V-301-10D10	EX-HA000637		V	PL00V-301-10M10	EX-HA000657
		W	PL00W-301-10D10	AC-HA000458		W	PL00W-301-10M10	AC-HA000304		W	PL00W-301-10D10	EX-HA000638		W	PL00W-301-10M10	EX-HA000658
		T	PL00T-301-10D10	AC-HA001382		T	PL00T-301-10M10	AC-HA001383		T	PL00T-301-10D10	EX-HA000639		T	PL00T-301-10M10	EX-HA000659
	D8	X	PL00X-501-10D8	AC-HA000568	M8	X	PL00X-501-10M8	AC-HA002460	D8	X	PL00X-501-10D8	EX-HA000793	M8	X	PL00X-501-10M8	EX-HA000798
		Y	PL00Y-501-10D8	AC-HA000569		Y	PL00Y-501-10M8	AC-HA002461		Y	PL00Y-501-10D8	EX-HA000794		Y	PL00Y-501-10M8	EX-HA000799
		U	PL00U-501-10D8	AC-HA000570		U	PL00U-501-10M8	AC-HA002462		U	PL00U-501-10D8	EX-HA000795		U	PL00U-501-10M8	EX-HA000800
		V	PL00V-501-10D8	AC-HA000571		V	PL00V-501-10M8	AC-HA002463		V	PL00V-501-10D8	EX-HA000796		V	PL00V-501-10M8	EX-HA000801
		W	PL00W-501-10D8	AC-HA000572		W	PL00W-501-10M8	AC-HA002464		W	PL00W-501-10D8	EX-HA000797		W	PL00W-501-10M8	EX-HA000802
		T	PL00T-501-10D8	AC-HA000573		T	PL00T-501-10M8	AC-HA002465		T	PL00T-501-10D8	EX-HA000798		T	PL00T-501-10M8	EX-HA000803
D10	X	PL00X-501-10D10	AC-HA000489	M10	X	PL00X-501-10M10	AC-HA000494	D10	X	PL00X-501-10D10	EX-HA000748	M10	X	PL00X-501-10M10	EX-HA000808	
	Y	PL00Y-501-10D10	AC-HA000490		Y	PL00Y-501-10M10	AC-HA000495		Y	PL00Y-501-10D10	EX-HA000809		Y	PL00Y-501-10M10	EX-HA000813	
	U	PL00U-501-10D10	AC-HA000491		U	PL00U-501-10M10	AC-HA000496		U	PL00U-501-10D10	EX-HA000810		U	PL00U-501-10M10	EX-HA000814	
	V	PL00V-501-10D10	AC-HA000492		V	PL00V-501-10M10	AC-HA000497		V	PL00V-501-10D10	EX-HA000811		V	PL00V-501-10M10	EX-HA000815	
	W	PL00W-501-10D10	AC-HA000493		W	PL00W-501-10M10	AC-HA000498		W	PL00W-501-10D10	EX-HA000812		W	PL00W-501-10M10	EX-HA000816	
	T	PL00T-501-10D10	AC-HA000494		T	PL00T-501-10M10	AC-HA000499		T	PL00T-501-10D10	EX-HA000813		T	PL00T-501-10M10	EX-HA000817	

With HVIL

Series Key	Thread Pin+(M+Stud Size)				Thread Pin+(M+Stud Size)			
	Termination	Description	Part Number	Termination	Description	Part Number	Termination	Description
300A	M8	X	PL00X-301-20M8	AC-HA021540	M10	X	PL00X-301-20M10	AC-HA021557
		Y	PL00Y-301-20M8	AC-HA021541		Y	PL00Y-301-20M10	AC-HA021558
		U	PL00U-301-20M8	AC-HA021542		U	PL00U-301-20M10	AC-HA



### Ordering Information-PowerLok™ 2POS Receptacle

PL 08 2X - 300 - 10 M10

Product Type	Connector Type	Key (Touch Proof Cover Color)	Current & HVIL	Termination Type	Termination Size
PowerLok™	08 2POS Receptacle	2X Orange	120 120 A W/O HVIL	10 Busbar Lug	D+Stud Size
			121 120 A With HVIL		M+Stud Size
		2Y Black	300 300 A W/O HVIL	20 Thread Pin	M+Thread Size
			301 300 A With HVIL		30 Tubular Lug

W/O HVIL													
Series	Key	Busbar Lug+(D+Stud Size)			Busbar Lug+(M+Stud Size)			Thread Pin+(M+Thread Size)			Tubular Lug+(D+Cable Size)		
		Termination	Description	Part Number	Termination	Description	Part Number	Termination	Description	Part Number	Termination	Description	Part Number
120A	X	D6	PL082X-120-10D6	AC-HA000771	M6	PL082X-120-10M6	AC-HA000773	-	-	-	-	-	-
			PL082Y-120-10D6	AC-HA000772		PL082Y-120-10M6	AC-HA000774	-	-	-	-	-	-
300A	X	D6	PL082X-300-10D6	AC-HA001210	M6	PL082X-300-10M6	AC-HA001212	M6	PL082X-300-20M6	AC-HA002527	35	PL082X-300-30D35	AC-HA001566
			PL082Y-300-10D6	AC-HA001211		PL082Y-300-10M6	AC-HA001213		PL082Y-300-20M6	AC-HA002528		PL082Y-300-30D35	AC-HA001567
	X	D8	PL082X-300-10D8	AC-HA000811	M8	PL082X-300-10M8	AC-HA000813	M8	PL082X-300-20M8	AC-HA000947	50	PL082X-300-30D50	AC-HA001568
			PL082Y-300-10D8	AC-HA000812		PL082Y-300-10M8	AC-HA000814		PL082Y-300-20M8	AC-HA000948		PL082Y-300-30D50	AC-HA001569
	X	D10	PL082X-300-10D10	AC-HA000807	M10	PL082X-300-10M10	AC-HA000809	M10	PL082X-300-20M10	AC-HA002529	70	PL082X-300-30D70	AC-HA001570
			PL082Y-300-10D10	AC-HA000808		PL082Y-300-10M10	AC-HA000810		PL082Y-300-20M10	AC-HA002530		PL082Y-300-30D70	AC-HA001571

With HVIL													
Series	Key	Busbar Lug+(D+Stud Size)			Busbar Lug+(M+Stud Size)			Thread Pin+(M+Thread Size)			Tubular Lug+(D+Cable Size)		
		Termination	Description	Part Number	Termination	Description	Part Number	Termination	Description	Part Number	Termination	Description	Part Number
120A	X	D6	PL082X-121-10D6	AC-HA000767	M6	PL082X-121-10M6	AC-HA000769	-	-	-	-	-	-
			PL082Y-121-10D6	AC-HA000768		PL082Y-121-10M6	AC-HA000770	-	-	-	-	-	-
300A	X	D6	PL082X-301-10D6	AC-HA001206	M6	PL082X-301-10M6	AC-HA001208	M6	PL082X-301-20M6	AC-HA002523	35	PL082X-301-30D35	AC-HA001560
			PL082Y-301-10D6	AC-HA001207		PL082Y-301-10M6	AC-HA001209		PL082Y-301-20M6	AC-HA002524		PL082Y-301-30D35	AC-HA001561
	X	D8	PL082X-301-10D8	AC-HA000803	M8	PL082X-301-10M8	AC-HA000805	M8	PL082X-301-20M8	AC-HA001507	50	PL082X-301-30D50	AC-HA001562
			PL082Y-301-10D8	AC-HA000804		PL082Y-301-10M8	AC-HA000806		PL082Y-301-20M8	AC-HA001508		PL082Y-301-30D50	AC-HA001563
	X	D10	PL082X-301-10D10	AC-HA000799	M10	PL082X-301-10M10	AC-HA000801	M10	PL082X-301-20M10	AC-HA002525	70	PL082X-301-30D70	AC-HA001564
			PL082Y-301-10D10	AC-HA000800		PL082Y-301-10M10	AC-HA000802		PL082Y-301-20M10	AC-HA002526		PL082Y-301-30D70	AC-HA001565

### Ordering Information-PowerLok™ 3POS Receptacle

PL 08 3X - 300 - 10 M10

Product Type	Connector Type	Key (Touch Proof Cover Color)	Current & HVIL	Termination Type	Termination Size
PowerLok™	08 3POS Receptacle	3X Orange	300 300A W/O HVIL	10 Busbar Lug	D+Stud Size
			301 300A With HVIL		M+Stud Size
		3Y Black	300 300A W/O HVIL	20 Thread Pin	M+Thread Size
			301 300A With HVIL		30 Tubular Lug

W/O HVIL													
Series	Key	Busbar Lug+(D+Stud Size)			Busbar Lug+(M+Stud Size)			Thread Pin+(M+Thread Size)			Tubular Lug+(D+Cable Size)		
		Termination	Description	Part Number	Termination	Description	Part Number	Termination	Description	Part Number	Termination	Description	Part Number
300A	X	D6	PL083X-300-10D6	AC-HA001152	M6	PL083X-300-10M6	AC-HA001154	M6	PL083X-300-20M6	AC-HA002451	35	PL083X-300-30D35	AC-HA001578
			PL083Y-300-10D6	AC-HA001153		PL083Y-300-10M6	AC-HA001155		PL083Y-300-20M6	AC-HA002452		PL083Y-300-30D35	AC-HA001579
	X	D8	PL083X-300-10D8	AC-HA001148	M8	PL083X-300-10M8	AC-HA001150	M8	PL083X-300-20M8	AC-HA001513	50	PL083X-300-30D50	AC-HA001580
			PL083Y-300-10D8	AC-HA001149		PL083Y-300-10M8	AC-HA001151		PL083Y-300-20M8	AC-HA001514		PL083Y-300-30D50	AC-HA001581
	X	D10	PL083X-300-10D10	AC-HA001144	M10	PL083X-300-10M10	AC-HA001146	M10	PL083X-300-20M10	AC-HA002533	70	PL083X-300-30D70	AC-HA001581
			PL083Y-300-10D10	AC-HA001145		PL083Y-300-10M10	AC-HA001147		PL083Y-300-20M10	AC-HA002534		PL083Y-300-30D70	AC-HA001583

With HVIL													
Series	Key	Busbar Lug+(D+Stud Size)			Busbar Lug+(M+Stud Size)			Thread Pin+(M+Thread Size)			Tubular Lug+(D+Cable Size)		
		Termination	Description	Part Number	Termination	Description	Part Number	Termination	Description	Part Number	Termination	Description	Part Number
300A	X	D6	PL083X-301-10D6	AC-HA001140	M6	PL083X-301-10M6	AC-HA001142	M6	PL083X-300-20M6	AC-HA002449	35	PL083X-300-30D35	AC-HA001572
			PL083Y-301-10D6	AC-HA001141		PL083Y-301-10M6	AC-HA001143		PL083Y-300-20M6	AC-HA002450		PL083Y-300-30D35	AC-HA001573
	X	D8	PL083X-301-10D8	AC-HA001136	M8	PL083X-301-10M8	AC-HA001138	M8	PL083X-300-20M8	AC-HA001511	50	PL083X-300-30D50	AC-HA001574
			PL083Y-301-10D8	AC-HA001137		PL083Y-301-10M8	AC-HA001139		PL083Y-300-20M8	AC-HA001512		PL083Y-300-30D50	AC-HA001575
	X	D10	PL083X-301-10D10	AC-HA001132	M10	PL083X-301-10M10	AC-HA001134	M10	PL083X-300-20M10	AC-HA002531	70	PL083X-300-30D70	AC-HA001576
			PL083Y-301-10D10	AC-HA001133		PL083Y-301-10M10	AC-HA001135		PL083Y-300-20M10	AC-HA002532		PL083Y-300-30D70	AC-HA001577

(1) D=Through hole  
(2) M=Screw hole

### Ordering Information-PowerLok™ 1POS Assembled Plug W/O HVIL

PL 18 X - 300 - 70

Product Type	Connector Type	Key (Touch Proof Cover Color)	Current & HVIL	Accepted Cable Size(mm <sup>2</sup> )	Current Rating (A)
PowerLok™	18 Plug Connector, Straight, Shield	X Orange	200 200A W/O HVIL	25	120
		Y Black		35	150
		U Yellow		50	200
		V Green		70	250
	28 Plug Connector, Right Angle, Shield	U Yellow	300 300A W/O HVIL	35	150
		V Green		50	200
		W Red		70	250
		T Blue		95	300
48 Plug Connector, Straight, Un-shield	V Green	500 500A W/O HVIL	120	400	
			150	500	

W/O HVIL										
Series	Key	18: Plug Connector, Straight, Shield		28: Plug Connector, Right Angle, Shield		48: Plug Connector, Straight, Un-Shield		58: Plug Connector, Right Angle, Un-Shield		Part Number
		Description	Part Number	Description	Part Number	Description	Part Number	Description	Part Number	
25	X	PL18X-200-25	PL18X-200-25	PL28X-200-25	PL28X-200-25	PL48X-200-25	PL48X-200-25	PL58X-200-25	PL58X-200-25	PL58X-200-25
		PL18Y-200-25	PL18Y-200-25	PL28Y-200-25	PL28Y-200-25	PL48Y-200-25	PL48Y-200-25	PL58Y-200-25	PL58Y-200-25	PL58Y-200-25
		PL18U-200-25	PL18U-200-25	PL28U-200-25	PL28U-200-25	PL48U-200-25	PL48U-200-25	PL58U-200-25	PL58U-200-25	PL58U-200-25
		PL18V-200-25	PL18V-200-25	PL28V-200-25	PL28V-200-25	PL48V-200-25	PL48V-200-25	PL58V-200-25	PL58V-200-25	PL58V-200-25
		PL18W-200-25	PL18W-200-25	PL28W-200-25	PL28W-200-25	PL48W-200-25	PL48W-200-25	PL58W-200-25	PL58W-200-25	PL58W-200-25
		PL18T-200-25	PL18T-200-25	PL28T-200-25	PL28T-200-25	PL48T-200-25	PL48T-200-25	PL58T-200-25	PL58T-200-25	PL58T-200-25
200A	X	PL18X-200-35	PL18X-200-35	PL28X-200-35	PL28X-200-35	PL48X-200-35	PL48X-200-35	PL58X-200-35	PL58X-200-35	PL58X-200-35
		PL18Y-200-35	PL18Y-200-35	PL28Y-200-35	PL28Y-200-35	PL48Y-200-35	PL48Y-200-35	PL58Y-200-35	PL58Y-200-35	PL58Y-200-35
		PL18U-200-35	PL18U-200-35	PL28U-200-35	PL28U-200-35	PL48U-200-35	PL48U-200-35	PL58U-200-35	PL58U-200-35	PL58U-200-35
		PL18V-200-35	PL18V-200-35	PL28V-200-35	PL28V-200-35	PL48V-200-35	PL48V-200-35	PL58V-200-35	PL58V-200-35	PL58V-200-35
		PL18W-200-35	PL18W-200-35	PL28W-200-35	PL28W-200-35	PL48W-200-35	PL48W-200-35	PL58W-200-35	PL58W-200-35	PL58W-200-35
		PL18T-200-35	PL18T-200-35	PL28T-200-35	PL28T-200-35	PL48T-200-35	PL48T-200-35	PL58T-200-35	PL58T-200-35	PL58T-200-35
300A	X	PL18X-200-50	PL18X-200-50	PL28X-200-50	PL28X-200-50	PL48X-200-50	PL48X-200-50	PL58X-200-50	PL58X-200-50	PL58X-200-50
		PL18Y-200-50	PL18Y-200-50	PL28Y-200-50	PL28Y-200-50	PL48Y-200-50	PL48Y-200-50	PL58Y-200-50	PL58Y-200-50	PL58Y-200-50
		PL18U-200-50	PL18U-200-50	PL28U-200-50	PL28U-200-50	PL48U-200-50	PL48U-200-50	PL58U-200-50	PL58U-200-50	PL58U-200-50
		PL18V-200-50	PL18V-200-50	PL28V-200-50	PL28V-200-50	PL48V-200-50	PL48V-200-50	PL58V-200-50	PL58V-200-50	PL58V-200-50
		PL18W-200-50	PL18W-200-50	PL28W-200-50	PL28W-200-50	PL48W-200-50	PL48W-200-50	PL58W-200-50	PL58W-200-50	PL58W-200-50
		PL18T-200-50	PL18T-200-50	PL28T-200-50	PL28T-200-50	PL48T-200-50	PL48T-200-50	PL58T-200-50	PL58T-200-50	PL58T-200-50

Note: 1POS-500A Assembled Plug Cable type "5"="HS Cable"



### Ordering Information-PowerLok™ 1POS Assembled Plug With HVIL

PL 18 X - 301 - 70

Product Type	Connector Type	Key (Touch Proof Cover Color)	Current & HVIL	Accepted Cable Size(mm <sup>2</sup> )	Current Rating (A)
PowerLok™	18 Plug Connector, Straight, Shield	X Orange	201 200A W/O HVIL	25 35	120 150
		Y Black		50	200
	28 Plug Connector, Right Angle, Shield	U Yellow	301 300A W/O HVIL	35 50	150 200
		V Green		70	250
	48 Plug Connector, Straight, Un-shield	W Red	501 500A W/O HVIL	70 95	250 300
		T Blue		120 150	400 500

Series	Key	With HVIL							
		18: Plug Connector, Straight, Shield		28: Plug Connector, Right Angle, Shield		48: Plug Connector, Straight, Un-Shield		58: Plug Connector, Right Angle, Un-Shield	
		Description	Part Number	Description	Part Number	Description	Part Number	Description	Part Number
200A	25	X PL18X-201-25	AC-HA004290	PL28X-201-25	AC-HA004305	PL48X-201-25	PL48X-201-25	PL58X-201-25	PL58X-201-25
		Y PL18Y-201-25	AC-HA004291	PL28Y-201-25	AC-HA004306	PL48Y-201-25	PL48Y-201-25	PL58Y-201-25	PL58Y-201-25
		U PL18U-201-25	AC-HA004292	PL28U-201-25	AC-HA004307	PL48U-201-25	PL48U-201-25	PL58U-201-25	PL58U-201-25
		V PL18V-201-25	AC-HA004293	PL28V-201-25	AC-HA004308	PL48V-201-25	PL48V-201-25	PL58V-201-25	PL58V-201-25
		W PL18W-201-25	AC-HA004294	PL28W-201-25	AC-HA004309	PL48W-201-25	PL48W-201-25	PL58W-201-25	PL58W-201-25
		X PL18X-201-35	AC-HA004295	PL28X-201-35	AC-HA004310	PL48X-201-35	PL48X-201-35	PL58X-201-35	PL58X-201-35
	35	Y PL18Y-201-35	AC-HA004296	PL28Y-201-35	AC-HA004311	PL48Y-201-35	PL48Y-201-35	PL58Y-201-35	PL58Y-201-35
		U PL18U-201-35	AC-HA004297	PL28U-201-35	AC-HA004312	PL48U-201-35	PL48U-201-35	PL58U-201-35	PL58U-201-35
		V PL18V-201-35	AC-HA004298	PL28V-201-35	AC-HA004313	PL48V-201-35	PL48V-201-35	PL58V-201-35	PL58V-201-35
		W PL18W-201-35	AC-HA004299	PL28W-201-35	AC-HA004314	PL48W-201-35	PL48W-201-35	PL58W-201-35	PL58W-201-35
		X PL18X-201-50	AC-HA004300	PL28X-201-50	AC-HA004315	PL48X-201-50	PL48X-201-50	PL58X-201-50	PL58X-201-50
		Y PL18Y-201-50	AC-HA004301	PL28Y-201-50	AC-HA004316	PL48Y-201-50	PL48Y-201-50	PL58Y-201-50	PL58Y-201-50
50	U PL18U-201-50	AC-HA004302	PL28U-201-50	AC-HA004317	PL48U-201-50	PL48U-201-50	PL58U-201-50	PL58U-201-50	
	V PL18V-201-50	AC-HA004303	PL28V-201-50	AC-HA004318	PL48V-201-50	PL48V-201-50	PL58V-201-50	PL58V-201-50	
	W PL18W-201-50	AC-HA004304	PL28W-201-50	AC-HA004319	PL48W-201-50	PL48W-201-50	PL58W-201-50	PL58W-201-50	
	X PL18X-301-35	AC-HA000815	PL28X-301-35	AC-HA000845	PL48X-301-35	AC-HA002603	PL58X-301-35	AC-HA004440	
	Y PL18Y-301-35	AC-HA000816	PL28Y-301-35	AC-HA000846	PL48Y-301-35	AC-HA002604	PL58Y-301-35	AC-HA004441	
	U PL18U-301-35	AC-HA000817	PL28U-301-35	AC-HA000847	PL48U-301-35	AC-HA002605	PL58U-301-35	AC-HA004442	
300A	50	V PL18V-301-35	AC-HA000818	PL28V-301-35	AC-HA000848	PL48V-301-35	AC-HA002606	PL58V-301-35	AC-HA004443
		W PL18W-301-35	AC-HA000819	PL28W-301-35	AC-HA000849	PL48W-301-35	AC-HA002607	PL58W-301-35	AC-HA004444
		T PL18T-301-35	AC-HA001283	PL28T-301-35	AC-HA001289	PL48T-301-35	AC-HA008504	PL58T-301-35	AC-HA008510
		X PL18X-301-50	AC-HA000820	PL28X-301-50	AC-HA000850	PL48X-301-50	AC-HA002613	PL58X-301-50	AC-HA004445
		Y PL18Y-301-50	AC-HA000821	PL28Y-301-50	AC-HA000851	PL48Y-301-50	AC-HA002614	PL58Y-301-50	AC-HA004446
		U PL18U-301-50	AC-HA000822	PL28U-301-50	AC-HA000852	PL48U-301-50	AC-HA002615	PL58U-301-50	AC-HA004447
70	50	V PL18V-301-50	AC-HA000823	PL28V-301-50	AC-HA000853	PL48V-301-50	AC-HA002616	PL58V-301-50	AC-HA004448
		W PL18W-301-50	AC-HA000824	PL28W-301-50	AC-HA000854	PL48W-301-50	AC-HA002617	PL58W-301-50	AC-HA004449
		T PL18T-301-50	AC-HA001284	PL28T-301-50	AC-HA001290	PL48T-301-50	AC-HA008505	PL58T-301-50	AC-HA008511
		X PL18X-301-70	AC-HA000825	PL28X-301-70	AC-HA000855	PL48X-301-70	AC-HA002623	PL58X-301-70	AC-HA004450
		Y PL18Y-301-70	AC-HA000826	PL28Y-301-70	AC-HA000856	PL48Y-301-70	AC-HA002624	PL58Y-301-70	AC-HA004451
		U PL18U-301-70	AC-HA000827	PL28U-301-70	AC-HA000857	PL48U-301-70	AC-HA002625	PL58U-301-70	AC-HA004452
150	70	V PL18V-301-70	AC-HA000828	PL28V-301-70	AC-HA000858	PL48V-301-70	AC-HA002626	PL58V-301-70	AC-HA004453
		W PL18W-301-70	AC-HA000829	PL28W-301-70	AC-HA000859	PL48W-301-70	AC-HA002627	PL58W-301-70	AC-HA004454
		T PL18T-301-70	AC-HA001285	PL28T-301-70	AC-HA001291	PL48T-301-70	AC-HA008506	PL58T-301-70	AC-HA008512
		X PL18X-501-70-5	AC-HA006467	PL28X-501-70-5	AC-HA006638	-	-	-	-
		Y PL18Y-501-70-5	AC-HA006468	PL28Y-501-70-5	AC-HA006639	-	-	-	-
		U PL18U-501-70-5	AC-HA006469	PL28U-501-70-5	AC-HA006640	-	-	-	-
300A	70	V PL18V-501-70-5	AC-HA006470	PL28V-501-70-5	AC-HA006641	-	-	-	-
		W PL18W-501-70-5	AC-HA006471	PL28W-501-70-5	AC-HA006642	-	-	-	-
		X PL18X-501-95-5	AC-HA006462	PL28X-501-95-5	AC-HA006633	-	-	-	-
		Y PL18Y-501-95-5	AC-HA006463	PL28Y-501-95-5	AC-HA006634	-	-	-	-
		U PL18U-501-95-5	AC-HA006464	PL28U-501-95-5	AC-HA006635	-	-	-	-
		V PL18V-501-95-5	AC-HA006465	PL28V-501-95-5	AC-HA006636	-	-	-	-
500A	120	W PL18W-501-95-5	AC-HA006466	PL28W-501-95-5	AC-HA006637	-	-	-	-
		X PL18X-501-120-5	AC-HA006457	PL28X-501-120-5	AC-HA006628	-	-	-	-
		Y PL18Y-501-120-5	AC-HA006458	PL28Y-501-120-5	AC-HA006629	-	-	-	-
		U PL18U-501-120-5	AC-HA006459	PL28U-501-120-5	AC-HA006630	-	-	-	-
		V PL18V-501-120-5	AC-HA006460	PL28V-501-120-5	AC-HA006631	-	-	-	-
		W PL18W-501-120-5	AC-HA006461	PL28W-501-120-5	AC-HA006632	-	-	-	-
150	150	X PL18X-501-150-5	AC-HA006452	PL28X-501-150-5	AC-HA006623	-	-	-	-
		Y PL18Y-501-150-5	AC-HA006453	PL28Y-501-150-5	AC-HA006624	-	-	-	-
		U PL18U-501-150-5	AC-HA006454	PL28U-501-150-5	AC-HA006625	-	-	-	-
		V PL18V-501-150-5	AC-HA006455	PL28V-501-150-5	AC-HA006626	-	-	-	-
		W PL18W-501-150-5	AC-HA006456	PL28W-501-150-5	AC-HA006627	-	-	-	-

Note: 1POS-500A Assembled Plug Cable type "5"="HS Cable"

### Ordering Information-PowerLok™ 2POS Assembled Plug

PL 48 2X - 300 - 70

Product Type	Connector Type	Key (Touch Proof Cover Color)	Current & HVIL	Accepted Cable Size(mm <sup>2</sup> )	Current Rating (A)
PowerLok™	18 Plug Connector, Straight, Shield	2X Orange	300 300A W/O HVIL	35	150
	28 Plug Connector, Right Angle, Shield		50	200	
	48 Plug Connector, Straight, Un-Shield	2Y Black	301 300A With HVIL	35	150
	58 Plug Connector, Right Angle, Un-Shield		50	200	
				70	250

Series	Key	18: Plug Connector, Straight, Shield		28: Plug Connector, Right Angle, Shield		48: Plug Connector, Straight, Un-Shield		58: Plug Connector, Right Angle, Un-Shield	
		Description	Part Number	Description	Part Number	Description	Part Number	Description	Part Number
<b>W/O HVIL</b>									
300A	35	2X PL182X-300-35	AC-HA000787	PL282X-300-35	AC-HA000793	PL482X-300-35	AC-HA002635	PL582X-300-35	AC-HA004490
		2Y PL182Y-300-35	AC-HA000788	PL282Y-300-35	AC-HA000794	PL482Y-300-35	AC-HA002636	PL582Y-300-35	AC-HA004491
	50	2X PL182X-300-50	AC-HA000789	PL282X-300-50	AC-HA000795	PL482X-300-50	AC-HA002639	PL582X-300-50	AC-HA004492
		2Y PL182Y-300-50	AC-HA000790	PL282Y-300-50	AC-HA000796	PL482Y-300-50	AC-HA002640	PL582Y-300-50	AC-HA004493
70	2X PL182X-300-70	AC-HA000791	PL282X-300-70	AC-HA000797	PL482X-300-70	AC-HA002643	PL582X-300-70	AC-HA004494	
	2Y PL182Y-300-70	AC-HA000792	PL282Y-300-70	AC-HA000798	PL482Y-300-70	AC-HA002644	PL582Y-300-70	AC-HA004495	
<b>With HVIL</b>									
300A	35	2X PL182X-301-35	AC-HA000775	PL282X-301-35	AC-HA000781	PL482X-301-35	AC-HA002446	PL582X-301-35	AC-HA002448
		2Y PL182Y-301-35	AC-HA000776	PL282Y-301-35	AC-HA000782	PL482Y-301-35	AC-HA002634	PL582Y-301-35	AC-HA004485
	50	2X PL182X-301-50	AC-HA000777	PL282X-301-50	AC-HA000783	PL482X-301-50	AC-HA002637	PL582X-301-50	AC-HA004486
		2Y PL182Y-301-50	AC-HA000778	PL282Y-301-50	AC-HA000784	PL482Y-301-50	AC-HA002638	PL582Y-301-50	AC-HA004487
	70	2X PL182X-301-70	AC-HA000779	PL282X-301-70	AC-HA000785	PL482X-301-70	AC-HA002641	PL582X-301-70	AC-HA004488
		2Y PL182Y-301-70	AC-HA000780	PL282Y-301-70	AC-HA000786	PL482Y-301-70	AC-HA002642	PL582Y-301-70	AC-HA004489

### Ordering Information-PowerLok™ 3POS Assembled Plug

PL 28 3X - 301 - 70

Product Type	Connector Type	Key (Touch Proof Cover Color)	Current & HVIL	Accepted Cable Size(mm <sup>2</sup> )	Current Rating (A)
PowerLok™	18 Plug Connector, Straight, Shield	3X Orange	300 300A W/O HVIL	35	150
	28 Plug Connector, Right Angle, Shield		50	200	
	48 Plug Connector, Straight, Un-Shield	3Y Black	301 300A With HVIL	35	150
	58 Plug Connector, Right Angle, Un-Shield		50	200	
				70	250

Series	Key	18: Plug Connector, Straight, Shield		28: Plug Connector, Right Angle, Shield		48: Plug Connector, Straight, Un-Shield		58: Plug Connector, Right Angle, Un-Shield	
		Description	Part Number	Description	Part Number	Description	Part Number	Description	Part Number
<b>W/O HVIL</b>									
300A	35	3X PL183X-300-35	AC-HA001114	PL283X-300-35	AC-HA001126	PL483X-300-35	-	PL583X-300-35	-
		3Y PL183Y-300-35	AC-HA001115	PL283Y-300-35	AC-HA001127	PL483Y-300-35	-	PL583Y-300-35	-
	50	3X PL183X-300-50	AC-HA001116	PL283X-300-50	AC-HA001128	PL483X-300-50	-	PL583X-300-50	-
		3Y PL183Y-300-50	AC-HA001117	PL283Y-300-50	AC-HA001129	PL483Y-300-50	-	PL583Y-300-50	-
	70	3X PL183X-300-70	AC-HA001118	PL283X-300-70	AC-HA001130	PL483X-300-70	-	PL583X-300-70	-
		3Y PL183Y-300-70	AC-HA001119	PL283Y-300-70	AC-HA001131	PL483Y-300-70	-	PL583Y-300-70	-
<b>With HVIL</b>									
300A	35	3X PL183X-301-35	AC-HA001108	PL283X-301-35	AC-HA001120	PL483X-301-35	-	PL583X-301-35	-
		3Y PL183Y-301-35	AC-HA001109	PL283Y-301-35	AC-HA001121	PL483Y-301-35	-	PL583Y-301-35	-
	50	3X PL183X-301-50	AC-HA001110	PL283X-301-50	AC-HA001122	PL483X-301-50	-	PL583X-301-50	-
		3Y PL183Y-301-50	AC-HA001111	PL283Y-301-50	AC-HA001123	PL483Y-301-50	-	PL583Y-301-50	-



### Ordering Information-PowerLok™ 1POS Overmolded Plug

Product Type	Connector Type	Key (Touch Proof Cover Color)		Current & HVIL		Accepted Cable Size(mm <sup>2</sup> )	Current Rating (A)
		Key	Color	Current	HVIL		
PowerLok™	10 1POS Plug Straight	X	Orange	120	120A W/O HVIL	16	90
		Y	Black	121	120A With HVIL	25	120
		U	Yellow	300	300A W/O HVIL	35 50	150 200
	20 1POS Plug Right Angle	V	Green	301	300A With HVIL	70 95	250 300
		W	Red	500	500A W/O HVIL	95 120	300 400
		T	Blue	501	500A With HVIL	135	450
						150	500

### Ordering Information-PowerLok™ 2POS Overmolded Plug

Product Type	Connector Type	Key (Touch Proof Cover Color)		Current & HVIL		Accepted Cable Size(mm <sup>2</sup> )	Current Rating (A)
		Key	Color	Current	HVIL		
PowerLok™	10 2POS Plug Straight	2X	Orange	120	120A W/O HVIL	16	90
	20 2POS Plug Right Angle	2Y	Black	121	120A With HVIL	25	120

**⚠ The information contained in this data sheet is for reference only**

Amphenol Technical Products International provides the above product specifications for the standard. Specifications are subject to change without notice. Contact your nearest Amphenol Corporation Sales Office for the latest specifications. All statements, information and data given herein are believed to be accurate and reliable but are presented without representation or warranty that any such use is free of patent infringement and are not recommendations to infringe any patent. Specifications are typical and may not apply to all connectors. Note that these specifications are derived from relevant global standards used in the automotive and industrial transportation markets, but they are not a substitute for system level design validation testing, which is the sole responsibility of the system designer and/or end user.